



---

# Battery Operated Carbon Monoxide Alarm

---

## User's Guide

---

Battery operated CO alarm  
without Digital display

ASSEMBLY: 9C05

Battery operated CO alarm  
With Digital Display and  
Peak Level memory

ASSEMBLY: 900-0146

*For questions concerning your Carbon Monoxide Alarm,  
please call Kidde Safety Europe on 01753 685148*

*Please have the following information ready when calling:*

CO Alarm Model Number (Located on the back of alarm):
CO Alarm Assembly Number (Located on back of alarm):
Date of Manufacture (Located on back of alarm):
Date of Purchase:
Where Purchased:

THIS OWNER'S MANUAL SHOULD BE READ, IN FULL AND RETAINED FOR THE LIFE OF THE PRODUCT. IT SHOULD ALSO BE PASSED ON TO ANY SUBSEQUENT OWNER.



KM 98848  
EN50291:2001

810-2241  
REV A 8/05

# Contents

---

## CONTENTS OF THIS MANUAL

- 1 -- CARBON MONOXIDE OVERVIEW
- 2 -- QUICK SET-UP
- 3 -- INSTALLATION INSTRUCTIONS
- 4 -- FEATURES AND OPERATION
- 5 -- BATTERY INSTALLATION
- 6 -- WHAT TO DO IF THE ALARM SOUNDS
- 7 -- CARING FOR YOUR KIDDE CO ALARM
- 8 -- PRODUCT SPECIFICATIONS
- 9 -- WARRANTY

## Environmental Protection

Waste electrical products should not be disposed of with household waste. Please recycle where facilities exist. Check with Local Authority or retailer for recycling advice.



**WARNING: THIS CARBON MONOXIDE ALARM IS NOT A SUBSTITUTE FOR INSTALLING AND MAINTAINING AN APPROPRIATE NUMBER OF SMOKE ALARMS IN YOUR HOME. THIS ALARM WILL NOT SENSE SMOKE, FIRE, OR ANY POISONOUS GAS OTHER THAN CARBON MONOXIDE. FOR THIS REASON YOU MUST INSTALL SMOKE ALARMS TO PROVIDE EARLY WARNING OF FIRE AND TO PROTECT YOU AND YOUR FAMILY FROM FIRE AND ITS RELATED HAZARDS.**

**WARNING: THIS PRODUCT IS INTENDED FOR USE IN ORDINARY INDOOR RESIDENTIAL AREAS. IT IS NOT DESIGNED TO MEASURE COMPLIANCE WITH COMMERCIAL AND INDUSTRIAL STANDARDS. THIS ALARM IS NOT SUITABLE FOR INSTALLATION IN HAZARDOUS LOCATIONS AS DEFINED IN THE NATIONAL ELECTRICAL CODE. INDIVIDUALS WITH MEDICAL PROBLEMS MAY CONSIDER USING WARNING DEVICES WHICH PROVIDE AUDIBLE AND VISUAL SIGNALS FOR CARBON MONOXIDE CONCENTRATIONS UNDER 30 PPM.**

**IMPORTANT: THIS CARBON MONOXIDE ALARM IS DESIGNED TO DETECT CARBON MONOXIDE FROM ANY SOURCE OF IMPROPER OR MALFUNCTIONING APPLIANCES. THE INSTALLATION OF THIS DEVICE SHOULD NOT BE USED AS A SUBSTITUTE FOR PROPER INSTALLATION, USE AND MAINTENANCE OF FUEL BURNING APPLIANCES INCLUDING APPROPRIATE VENTILATION AND EXHAUST SYSTEMS**

**WARNING: THIS ALARM WILL NOT WORK WITHOUT POWER. THIS ALARM REQUIRES A CONTINUOUS SUPPLY OF POWER.**

**WARNING: THIS UNIT IS NOT A SMOKE ALARM. IT WILL NOT SENSE SMOKE OR FIRE. FOR EARLY WARNING OF FIRE YOU MUST INSTALL SMOKE ALARMS, EVEN THOUGH CARBON MONOXIDE CAN BE GENERATED BY FIRE.**

Thank you for the purchase of your new Kidde carbon monoxide alarm. If you have any questions about the operation or setup of your CO alarm, feel free to call us on 01753 685148

# Carbon Monoxide Overview

---

Your new Kidde Carbon Monoxide (CO) Alarm is a sophisticated instrument that has been carefully designed and tested to detect CO build up in a residential environments. Your alarm is for use specifically in the home.

CO cannot be seen, smelled or tasted and can be fatal. The build up of CO in the blood is called the carboxyhemoglobin level and interferes with the body's ability to supply itself with oxygen. Depending on the concentration, carbon monoxide can kill in minutes.

The most common sources of CO are malfunctioning, or misuse of, gas appliances used for heating and cooking, vehicles engines, electric generators, blocked chimneys or flues, portable fuel burning heaters, fireplaces, fuel powered tools and operating a grill in an enclosed space.

Indications of CO poisoning include symptoms similar to the flu, but with no fever. Other symptoms include dizziness, fatigue, weakness, headache, nausea, vomiting, sleepiness and confusion. Everyone is susceptible to the danger of CO, but unborn babies, small children, pregnant women, senior citizens and people with heart or respiratory problems may experience symptoms sooner. Each year a qualified Corgi (gas) or Hetas (solid fuel) engineer should inspect and clean your heating system, vents, chimney, and flues.

Your new Kidde CO alarm has a five year<sup>0</sup> warranty. Please take a few minutes to thoroughly read the user's guide and familiarize yourself and your family with its operation. Your Kidde CO alarm was designed to detect carbon monoxide gas from ANY source of combustion. It is NOT designed to detect smoke, fire or any other gases. If you have any questions please call us on 01753 685148.

This manual and the products described are copyrighted, with all rights reserved. Under these copyright laws, no part of this manual may be copied for use without the written consent of Kidde.

If you require further information, contact our Consumer Hotline, or write to us at:

**Kidde Safety Europe Ltd**  
**Mathisen Way, Poyle Road,**  
**Colnbrook, Berkshire**  
**SL3 0HB**  
**Customer Hotline: 0800 917 0722**  
**[www.kiddesafetyeurope.co.uk](http://www.kiddesafetyeurope.co.uk)**

# Kidde Product View

900-0146 digital display model

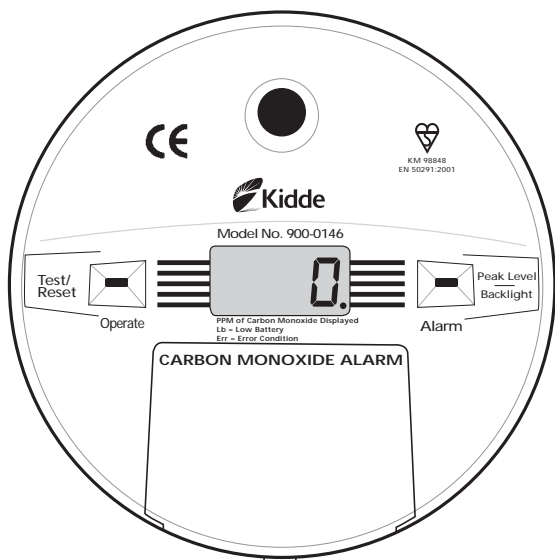

# Kidde Product View

9CO5 non-digital model

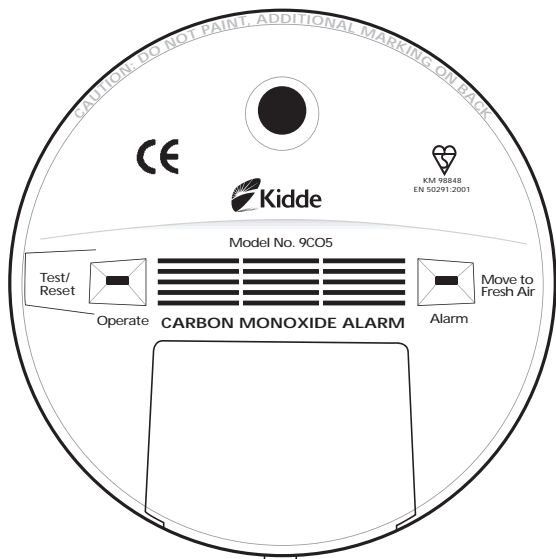

## Quick Set Up

---

NOTE: This CO alarm must be installed by a competent person.

Remove the three enclosed AA batteries and install them into the battery well. Carefully place the red battery warning flags into the battery well. Observe the battery polarity markings at the bottom of the battery well. After approximately 30 seconds, your CO alarm will begin monitoring for CO.

Your Kidde CO Alarm is now operational.

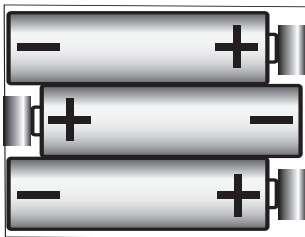

### IMPORTANT

A small screwdriver or similar tool may be required when opening the battery compartment cover. This should be levered from the lip at the bottom of the cover.

The cover is designed this way to discourage the removal of batteries, or tampering, by young children.

# Installation Instructions

---

## Installation Location

When choosing your installation locations, make sure you can hear the alarm from all sleeping areas. If you install only one carbon monoxide alarm in your home, install the alarm near bedrooms, not in the cellar or boiler room.

## Recommended Locations

### Upper Levels of the Home

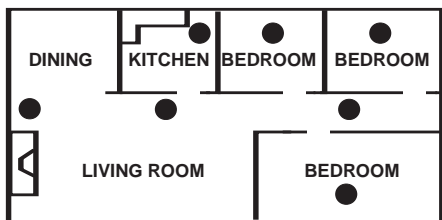

If you have only one alarm, place it near sleeping areas.

# Installation Instructions

---

## Where To Install Your Kidde CO Alarm

The following suggestions are intended to help you with the placement and installation of your Kidde CO Alarm.

- Place out of the reach of children. Under no circumstance should children be allowed to handle or install the CO alarm.
- Install in a bedroom or hallway located close to the sleeping area. Take special care to verify the alarm can be heard in sleeping areas.
- It is recommended that a CO alarm be installed on each level of a multi-level home.
- Locate at least [but no closer than] 2 metres away from all fuel burning appliances.
- Placing at eye level allows for optimum monitoring of the red and green indicator lights, or, as a guide, 1.5 metres from the floor.
- Ensure that all vents of the unit are unobstructed.
- Do not install in dead air spaces such as peaks of vaulted ceilings, or gabled roofs.
- Do not install in turbulent air from ceiling fans.
- Do not place near fresh air vents or close to doors and windows that open to the outside.
- Keep the CO alarm away from excessively dusty, dirty, or greasy areas such as kitchens, garages and boiler or utility rooms. Dust, grease and household chemicals can affect the sensor.
- Keep out of damp and humid areas such as the bathroom. Avoid spraying aerosols near the CO alarm.
- Do not install in areas where the temperature is below 40°F (4.4°C) or hotter than 100°F (37.8°C).
- Do not place behind curtains or furniture. CO must be able to reach the sensor for the unit to accurately detect carbon monoxide. **NEVER** place the CO alarm flat on a table top or similar surface.
- Be aware that certain conditions can result in transient CO situations, such as:
  - 1) Excessive spillage or reverse venting of fuel burning appliances caused by outdoor ambient conditions, such as:
    - i) Wind direction and/or velocity, including high gusts of wind. Heavy air in the vent pipes (cold/humid air with extended periods between cycles).



- ii) negative pressure differential resulting from the use of exhaust fans.
- iii) Simultaneous operation of several fuel burning appliances competing for limited internal air.
- iv) Vent pipe connections vibrating loose from clothes dryers, boilers or water heaters.
- v) Obstructions in or unconventional vent pipe designs which can amplify the above situations.

2) Extended operation of unvented fuel burning devices (cooker, oven, fire-place, etc.).

3) Temperature inversions which can trap exhaust near the ground.

4) Car idling in open or closed garage, or near the home.

## Mounting

Your CO alarm is designed for mounting on the side wall.

You should fix the back plate provided to the wall first using screws and rawl plugs.

When the plate is attached, locate the slots on the back of the alarm with the keys on the back plate, sliding downward and into position until the unit clips onto the top of the alarm.

To remove, press the tab against the wall and lift the alarm out of the mounting plate.

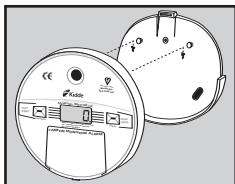
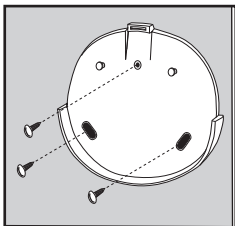

NOTE: Your 9C05 or 900-0146 CO alarm is not designed for portability.

## Features and Operation of Digital Display Model

---

Your new Kidde Battery Powered CO Alarm utilizes sophisticated electronic components to protect you and your family from the dangers of CO.

Unique features include a digital display capable of displaying CO concentrations in (PPM) Parts Per Million and the highest levels of CO detected. Familiarize yourself with these features:

### Digital Display Backlight Feature

To help see the displayed reading in the dark, a backlight appears when the peak level button is pressed.

### Digital Display - Shows CO level in PPM

Your Kidde CO alarm continuously displays a digital readout of the CO level in Parts Per Million (PPM). The digital display is capable of detecting and displaying readings between 30 and 999 (PPM).



***A reading of 0 PPM is expected under normal conditions***

You will become accustomed to glancing at the display in much the same manner as you look at a thermometer or clock. **The unit will not automatically display a reading below 30 PPM.** However, readings between 11 and 999 PPM will be stored in the Peak Level Memory.

### Other Possible Displays and Their Meanings

The following symbols will appear on the display during normal or error operations, and are explained below.

#### Normal Operation

Normal operation with a full battery. The dot in the lower right corner cycles on and off every 5 seconds. If CO is present the display will indicate the reading in Parts Per Million (PPM).



#### Normal Operation following Power-up or Reset

The figure at the right shows the normal display immediately after installing batteries or after the test/reset button is pressed. The display will change to the normal display approximately 30 seconds after pressing the test/reset button.



## Features and Operation of Digital Display Model

---

If the test/reset button is pressed, the alarm will sound. The display will show a number during the time that the alarm is sounding. This number is a normal part of the test function, and does not indicate a CO reading.

### Peak Level Display

When the peak level button is pressed and held, the display shows the highest CO reading taken by the CO alarm since its last peak level reset or power-up. The backlight will illuminate for several seconds after the peak level button is pressed to help you see the reading.

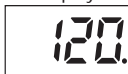

Although the peak level feature will display levels below 30 PPM, these levels will not result in an alarm no matter how long the device is exposed to these levels.

The peak level feature is helpful in identifying CO occurrences below 30 PPM. Although the unit will not automatically display levels below 30 PPM, it will detect and store these readings in memory. By pressing the peak level button, concentration levels as low as 11 and up to 999 PPM will be displayed.

Concentrations of CO between 0 and 30 PPM can often occur in normal, everyday conditions. Concentrations of CO below 30 PPM may be an indication of a transient condition that may appear today and never reappear. Just a few examples of conditions and/or sources that may cause readings below 30 PPM are heavy automobile traffic, starting a vehicle in an attached garage, an appliance that emits CO when starting up, a fire in a fireplace or charcoal in a nearby barbecue. A temperature inversion can trap CO generated by traffic and other fuel burning appliances causing readings of CO.

Some CO conditions may start out below 30 PPM but could develop into CO concentrations that could become harmful. If this happens, the CO alarm will detect the dangerous level and alarm, notifying you and others of the conditions. DO NOT ignore high concentration readings above 30 PPM or a CO alarming device that is in alarm.

# Features and Operation of Digital Display Model

---

## Resetting the Peak Level Reading

To reset or clear the peak level reading, press and hold the peak level button and then press and hold the test/reset button at the same time. The number on the display will return to 0 PPM. CO concentrations displayed below 30 PPM in memory are for reference only and the accuracy of the concentration shown may not be as accurate as noted in the Product Specification section.

*Note: The peak level reading will also be reset when the batteries are removed.*

## Unit Replacement

Seven years after initial power up, this unit will "chirp" every 30 seconds to indicate that it is time to replace the alarm.

The unit will not detect CO in this condition. Please replace immediately.

*Note: Your Kidde CO Alarm will NOT monitor CO levels while an error warning is being displayed.*

## Unit Malfunction

In the rare event that your alarm malfunctions, it will alert you with a short "chirp" and the red LED will flash once every 30 seconds. The digital model will display "Err" as shown.



## Low Battery

If the batteries become "low", the alarm will alert you with a short "chirp" and the red LED will flash once every 30 seconds for up to 7 days. The digital models will display "Lb" as shown



# Features and Operation of Digital Display and Non-digital Display Models

---

## Test/Reset Button

The test/reset button is used to test the unit's electronics and to reset the unit during alarm.

### Test the unit:

- Test the unit - To test, press and release the test/reset button, you should hear one short beep - followed by 5 seconds of silence – followed by a continuous alarm with a corresponding red LED flash.

Familiarise yourself and family members with the alarm pattern.

Test the unit weekly! If at any time your unit does not perform as described replace it immediately.

### *Note: For Digital Display Models*

*After the test/reset button is pressed, numbers appear on the display. These are not CO readings and are part of the internal testing process. Ignore these numbers !*

Due to the loudness of the alarm we suggest you place your fingers over the sounder opening when testing your Kidde CO Alarm.

## Reset

If the alarm is sounding, pressing the test/reset button will terminate the alarm. If the CO condition that caused the alert in the first place continues, the alarm will reactivate. Reactivation times depend on the amount of CO that caused the CO alarm to initially alarm and the amount of CO present after resetting the alarm .

If this happens follow **What To Do If The Alarm Sounds** on pages 17-19

**WARNING: Tampering with your alarm may cause a malfunction.  
Please follow manufacturer's instructions at all times.**

# Features and Operation of Digital Display and Non-Digital Display Models

---

## Lights

### Red Alarm Indicator Light

If a dangerous level of carbon monoxide is detected by your Kidde alarm, the red alarm LED will flash on and off continuously and a loud (85decibel) alarm will sound.

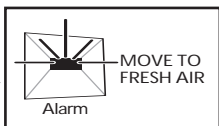

### Green Operate Light

The green light flashing every 30 seconds indicates the unit is functioning properly. The green light will flash before a CO reading is taken and when any button is pressed. If the unit chirps once every 30 seconds, observe the unit for the following:

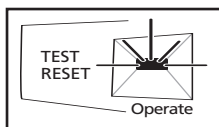

chirps once every 30 seconds, observe the unit for the following:

A chirp every 30 seconds, with a green LED flash followed by a red LED flash, indicates the batteries are low. Follow the battery installation/replacement instructions.

A chirp every 30 seconds, with a red flash and no green LED flash indicates a unit error.

If the unit does not respond, call Kidde on 01753 685148.

# Battery Installation/Replacement

---

## Installation/Replacement

Since batteries are not installed in the unit at the factory, you will need to install them.

Your Kidde unit will continue to remind you to change the batteries for up to seven days after low batteries are detected.

**WARNING:** Your Kidde CO alarm will not be operational and will not monitor for CO levels without the installation of three charged AA batteries.

Your Kidde CO alarm monitors for battery failure such as bad or corroded connections, sudden battery failure and other causes. If the alarm senses any form of battery failure, the unit will start chirping an audible alarm every 30 seconds, the green and red alarm light will flash. The battery error warning will continue until new batteries are placed in the unit, or until the remaining batteries become completely exhausted.

Three AA batteries have been included with your purchase. When replacing the batteries, we recommend use of the following battery types:

- Duracell MN1500
- Rayovac 815
- Energizer E91

Under normal operating conditions, the batteries will last a minimum of one year. These batteries can be purchased at your local retailer.

**Note:** *Constant exposure to high or low humidity may reduce battery efficiency.*

## Battery Replacement/Installation Instructions

To install or replace the batteries in your Kidde unit please perform the following steps:

1. Gently lift open the battery cover to expose the battery compartment.

Note: You will require a small screw driver or similar tool for this procedure.

2. Remove the old batteries and properly dispose of them as recommended by the battery manufacturer.

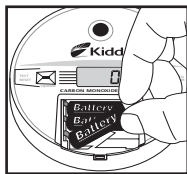

## Battery Installation/Replacement

---

3. Reinstall the new batteries. Be careful to seat the red battery warning flags in the recess of the battery well. Also, note the polarity illustration in the bottom of the battery compartment. If applicable, the unit will chirp and display for approximately one minute and return to normal operation.
4. Gently close the cover. **The cover of your CO alarm will NOT close if all three AA batteries are not properly installed.**

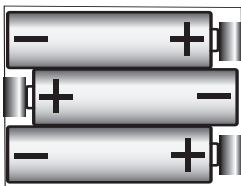

**NOTE:** Ensure that you observe the correct battery polarities required during battery installation. Incorrect battery insertion will make your CO alarm inoperable.



## Part Four – What to do When the Alarm Sounds

---



**WARNING:** Actuation of your CO Alarm indicates the presence of Carbon Monoxide (CO) which can KILL YOU.

When the CO alarm senses a dangerous level of CO, the unit will emit a loud alarm pattern.



**WARNING!** - Actuation of this device indicates the presence of dangerous levels of carbon monoxide! Carbon monoxide can be fatal! If the alarm sounds:

- 1) Operate the test/reset button;
- 2) Call Transco (British Gas)

<small>PHONE NUMBER</small>
<b>0800 111 999</b>

- 3) Immediately move to fresh air outdoors. Do a head count to check that all persons are accounted for. Do not re-enter the premises until British Gas has arrived, the premises has been aired out, and your alarm remains in its normal condition.
- 4) After following steps 1-3, if your alarm reactivates within a 24 hour period, repeat steps 1-3 and call a qualified Corgi installer to examine and/or turn off your gas/oil fired appliances, such as space heater, boiler, water heater, cooker, oven, clothes dryer, or other sources of combustion, such as paraffin burning stove or heater or gas log fireplace. If your car is idling in an attached garage turn off the engine.

# What To Do If The Alarm Sounds

---

## Alarm/Danger Levels

**Caution: This CO alarm will only indicate the presence of CO at the sensor. CO may be present in other areas.**

**Common Mild Exposure Symptoms:**

Slight headache, nausea, vomiting, fatigue ("flu-like" symptoms).

**Common Medium Exposure Symptoms:**

Throbbing headache, drowsiness, confusion, fast heart rate.

**Common Extreme Exposure Symptoms:**

Convulsions, unconsciousness, heart and lung failure. It can cause brain damage and death. Many cases of reported CARBON MONOXIDE POISONING indicate that while victims are aware they are not well, they become so disoriented they are unable to save themselves by either exiting the building or calling for assistance. Also young children and

household pets may be the first affected.

Familiarisation with the effects of each level is important. The symptoms described in the chart above are related to carbon monoxide poisoning and should be discussed with ALL members of the household.

***Exposure to high levels of carbon monoxide can be fatal or cause permanent damage and disabilities.***

If you experience any symptoms of carbon monoxide poisoning, consult your doctor immediately! CO poisoning can be determined by a simple blood test called a carboxy-haemoglobin test. Severe cases may require treatment in a hyperbaric chamber. Remember, young children and household pets may be the first effected.

***If you have additional questions please call  
Klde on 01753 685148***

## What To Do If The Alarm Sounds

---

Because carbon monoxide is a cumulative poison, long-term exposures to low levels may cause symptoms, as well as short-term exposures to high levels. This Kidde unit has a time-weighted alarm - the higher the level of carbon monoxide present, the sooner the alarm will be triggered.

This CO alarm can only warn you of the presence of CO. It does not prevent CO from occurring, nor can it solve an existing CO problem. If your unit has alarmed and you've provided ventilation by leaving your windows and doors open, the CO buildup may have dissipated by the time help responds. Although your problem may appear to be temporarily solved, it's crucial that the source of the CO is determined and that the appropriate repairs are made.

<b>THIS CO ALARM MEETS THE FOLLOWING ALARM TIME / CONCENTRATIONS REQUIREMENTS:</b>
--

At 30 PPM, the unit cannot alarm in less than 120 minutes
---

At 50 PPM, the unit must alarm within 60-90 minutes
---

At 100 PPM, the unit must alarm within 10-40 minutes
--

At 300 PPM, the unit must alarm within 3 minutes
--

### WARNING

This product is intended for use in ordinary indoor locations of family living units. It is not designed to measure compliance with Occupational Safety and the Health & Safety Executive (HSE).

This device is designed to protect individuals from acute effects of carbon monoxide exposure. It may not fully safeguard individuals with specific medical conditions. If in doubt, consult a medical practitioner. Individuals with medical problems may consider using warning devices, which provide audible and visual signals for carbon monoxide concentrations under 30 ppm.

# Caring for your Kidde Battery Powered CO Alarm

---

To keep your CO alarm in good working order, please follow these simple steps:

- Verify unit alarm, lights and battery operation by pushing the test button once a week.
- Vacuum the CO alarm cover with a soft brush attachment once a month to remove accumulated dust.
- Instruct children never to play with the CO alarm. Warn children of the dangers of carbon monoxide poisoning.
- Never use detergents or other solvents to clean the CO alarm.
- Avoid spraying air freshener, hair spray, paint or other aerosols near the CO alarm.
- **Do not paint the CO alarm.** Paint will seal the vents and interfere with the sensor ability to detect CO.
- Do not place near a nappy bucket.

Move the CO alarm and place in another location prior to performing any of the following:

- Staining or stripping wood floors or furniture
- Painting
- Wall papering
- Using adhesives

Storing the unit in a plastic bag during the above projects will protect the sensor from permanent damage.

**WARNING: As soon as possible, place the CO alarm back in its proper location to assure protection from Carbon Monoxide poisoning.**

Accommodation spaces should be well ventilated when household cleaning supplies or similar contaminants are used.

The following substances can affect the sensor and may cause false readings:

Methane, propane, iso-butane, iso-propanol, ethylene, benzene, toluene, ethyl acetate, hydrogen sulfide, sulfur dioxides, alcohol based products, paints, thinners, solvents, adhesives, hair sprays, after shaves, perfumes, and some cleaning agents.

# Troubleshooting Guide

---

Symptom	Problem	Action
1 chirp every 30 seconds with a red LED flash, digital units display <b>Lb</b>	<b>Batteries are low and need replacing.</b>	See Battery Installation/Replacement section.
1 chirp every 30 seconds with a red LED flash, digital units display <b>Err</b>	<b>Sensor or unit malfunction.</b>	Replace unit, if necessary

The problems listed above are under normal operation conditions. Other error (Err) conditions could exist if, for instance, ambient conditions are outside the normal operating range, or the battery condition is less than optimal. If you still have any additional questions regarding error conditions, please call us on 0 1753 685 148.

## Product Specifications

---

**POWER:** Three AA batteries (supplied)

**SENSOR:** Electrochemical carbon monoxide sensor

**ACCURACY:** Depending on the ambient condition (temperature, humidity) and the condition of the sensor, the alarm readings may vary. The digital reading tolerances are: Ambient: 27°C +/-12°C(80°F +/-10°F), atmospheric pressure +/-10%, 40%+/-3% relative humidity.

READING	TOLERANCE (OF DISPLAY READING)
---------	--------------------------------

0-999ppm	+20% +15ppm
----------	-------------

**TEMPERATURE:** Operating range 4.4°C (40°F) to 37.8°C (100°F)

**ALARM:** 85+ dB at 10' @ 3.4 ± 0.5 KHz pulsing alarm

**SIZE AND WEIGHT:** 140 mm diameter x 35.5 mm depth/0.30 kg. with batteries

# Warranty

---

WARRANTY COVERAGE: THE MANUFACTURER WARRANTS TO THE ORIGINAL CONSUMER PURCHASER, THAT THIS PRODUCT WILL BE FREE OF DEFECTS IN MATERIAL AND WORKMANSHIP FOR A PERIOD OF FIVE (5) YEARS FROM DATE OF PURCHASE. THE MANUFACTURER'S LIABILITY HEREUNDER IS LIMITED TO REPLACEMENT OF THE PRODUCT. REPAIR OF THE PRODUCT OR REPLACEMENT OF THE PRODUCT WITH REPAIRED PRODUCT AT THE DISCRETION OF THE MANUFACTURE. THIS WARRANTY IS VOID IF THE PRODUCT HAS BEEN DAMAGED BY ACCIDENT, UNREASONABLE USE, NEGLIGENCE, TAMPERING OR OTHER CAUSES NOT ARISING FROM DEFECTS IN MATERIAL OR WORKMANSHIP. THIS WARRANTY EXTENDS TO THE ORIGINAL CONSUMER PURCHASER OF THE PRODUCT ONLY.

Warranty Disclaimers: Any implied warranties arising out of this sale, including but not limited to the implied warranties of description, merchantability and fitness for a particular purpose, are limited in duration to the above warranty period. In no event shall the Manufacturer be liable for loss of use of this product or for any indirect, special, incidental or consequential damages, or costs, or expenses incurred by the consumer or any other user of this product, whether due to a breach of contract, negligence, strict liability in tort or otherwise. The Manufacturer shall have no liability for any personal injury, property damage or any special, incidental, contingent or consequential damage of any kind resulting from gas leakage, fire or explosion. This warranty does not affect your statutory rights.

Warranty Performance: During the above warranty period, your product will be replaced with a comparable product if the defective product is returned, postage prepaid, to KIDDE Safety Europe Ltd, Mathisen Way, Colnbrook, Slough SL3 0HB. Telephone 01753 685148, together with proof of purchase date. Please include a note describing the problem when you return the unit. The replacement product will be in warranty for the remainder of the original warranty period or for six months, whichever is longer. Other than the cost of postage, no charge will be made for replacement of the defective product.

*Important:* Do not remove back cover. Back cover removal will void warranty.

Your *Carbon Monoxide Alarm* is not a substitute for property, disability, life or other insurance of any kind. Appropriate insurance coverage is your responsibility. Consult your insurance agent.

Kidde makes no warranty, express or implied, written or oral, including that of merchantability or fitness for any particular purpose, with respect of the batteries.

## **For Warranty Service:**

In many cases the quickest way to exchange your CO alarm is to return it to the original place of purchase. If you have questions, call the KIDDE customer service department at on 01753 685148

Please send products and all other correspondence to:

Kidde Safety Europe Ltd  
Mathisen Way, Poyle Road,  
Colnbrook, Berkshire  
SL3 0HB



contact us at our website at  
[www.kiddesafetyeurope.co.uk](http://www.kiddesafetyeurope.co.uk)