

PRODUCT DATASHEET

PANEL VAL 600 36 W 4000 K WT

PANEL VALUE 600 | Square recessed panel luminaires, 600 x 600 mm

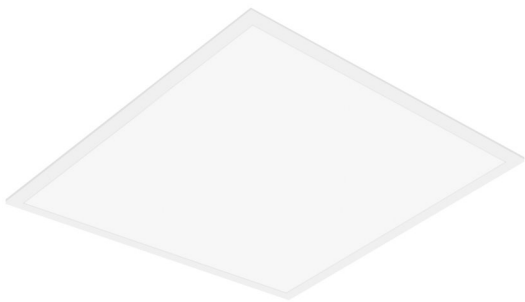

AREAS OF APPLICATION

- Direct replacement for luminaires with fluorescent lamps
- Offices, conference rooms
- Reception areas, foyers, corridors, elevators
- Suitable for recessed ceiling systems with grid size of 600 x 600 mm

PRODUCT BENEFITS

- Value for money luminaire
- Low flicker light thanks to special electronic control gear
- Energy savings thanks to system efficacy of up to 100 lm/W
- External driver for extended flexibility and easy installation
- Versions with DALI ECG available

PRODUCT FEATURES

- Lifetime (L70/B50): up to 50,000 h (at 25 °C)
- Extruded aluminum frame
- Polystyrene diffuser



TECHNICAL DATA

Electrical data

| | |
|--|---------------------|
| Nominal wattage | 36.00 W |
| Operating mode | External LED driver |
| Nominal voltage | 220...240 V |
| Mains frequency | 50/60 Hz |
| Power factor λ | >0.90 |
| Max. no. of lum. on circuit break. B16 A | 19 |
| Max. no. of lum. on circuit break. C10 A | 19 |
| Max. no. of lum. on circuit break. C16 A | 30 |
| Inrush current | 10.4 A |
| Total harmonic distortion | < 15 % |
| Inrush current time T_{h50} | 200 μ s |

Luminaire control gear data

| | |
|-----------------------------|------------|
| Low flicker | Yes |
| ECG - Output ripple current | \leq 5 % |

Photometrical data

| | |
|--------------------------------------|--------------------|
| Color temperature | 4000 K |
| Color rendering index Ra | >80 |
| Light color (designation) | Cool White |
| Luminous flux | 3600 lm |
| Luminous efficacy | 100 lm/W |
| Standard deviation of color matching | 5 sdc _m |

Light technical data

| | |
|------------|-------|
| Beam angle | 120 ° |
|------------|-------|

Dimensions & weight

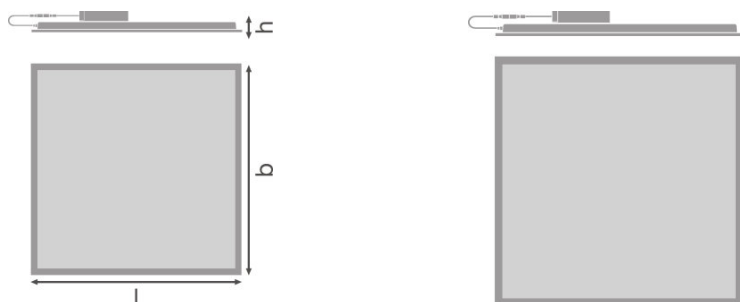

| | |
|------------------------|-----------|
| Length | 595.0 mm |
| Width | 595.0 mm |
| Height | 35.0 mm |
| Product weight | 1800.00 g |
| Mounting width | 580.0 mm |
| Mounting length | 580.0 mm |

Colors & materials

| | |
|--|-------------|
| Product color | White |
| Housing color | White |
| Body material | Aluminum |
| Light emitting surface material | Polystyrene |

Temperatures & operating conditions

| | |
|----------------------------------|--------------|
| Ambient temperature range | -10...+45 °C |
|----------------------------------|--------------|

Lifespan

| | |
|-----------------------------------|---------|
| Number of switching cycles | 25000 |
| Lifespan L70/B50 at 25 °C | 50000 h |
| Lifespan L80/B10 at 25 °C | 50000 h |
| Lifespan L90/B10 at 25 °C | 30000 h |

Additional product data

| | |
|--------------------------|------------------------------|
| Mounting type | Recessed/Suspended/Surface |
| Mounting location | Ceiling / Wall |
| Low flicker | Yes |
| Product remark | Available from February 2020 |

Capabilities

| | |
|-------------------------------|--------------------|
| Dimmable | No |
| Type of connection | Screwless terminal |
| LED module replaceable | Not replaceable |

Certificates & standards

| | |
|---|----------------|
| Type of protection | IP40 |
| Protection class | II |
| Protection class IK (shock resistance) | IK02 |
| Glow Wire Test according to IEC 60695-2-12 | 650 °C |
| Photobiological safety group EN62778 | RG0 |
| Standards | CE/CB/EAC/RoHS |

Light Distribution

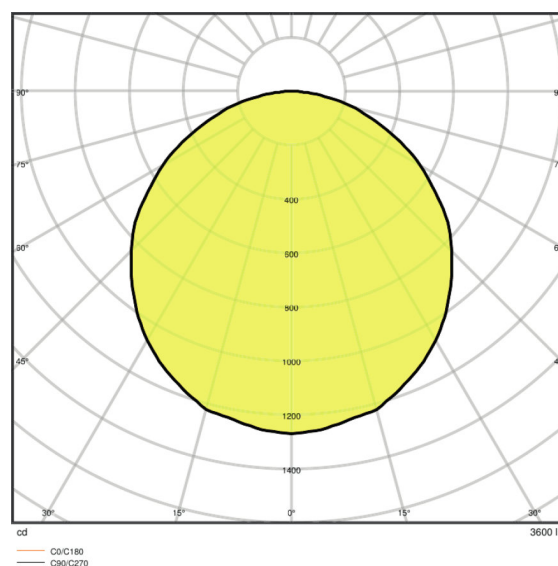

LDC typ cone

LDC typ polar

EQUIPMENT / ACCESSORIES

- Accessories for several mounting options available
- External control gear included
- Security brackets included

LOGISTICAL DATA

| Product code | Packaging unit (Pieces/Unit) | Dimensions (length x width x height) | Gross weight | Volume |
|--------------|------------------------------|--------------------------------------|--------------|--------|
|--------------|------------------------------|--------------------------------------|--------------|--------|

| | | | | |
|---------------|--------------------------|--------------------------|------------|-----------------------|
| 4058075392380 | Folding carton box 1 | 602 mm x 40 mm x 648 mm | 2192.00 g | 15.60 dm ³ |
| 4058075392397 | Shipping carton box 4 | 667 mm x 182 mm x 634 mm | 10015.00 g | 76.96 dm ³ |

The mentioned product code describes the smallest quantity unit which can be ordered. One shipping unit can contain one or more single products. When placing an order, for the quantity please enter single or multiples of a shipping unit.

ADDITIONAL CATALOG INFORMATION

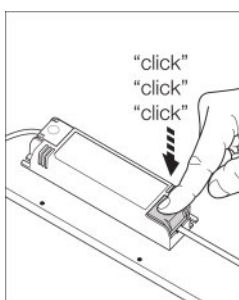
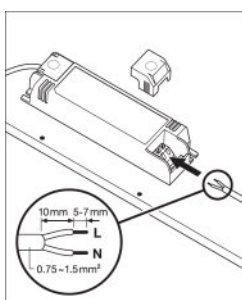

REFERENCES / LINKS

For Guarantee see

- ▶ www.ledvance.com/guarantee

DISCLAIMER

Subject to change without notice. Errors and omission excepted. Always make sure to use the most recent release.