

Data sheet Illuminated pushbutton Ø 22 mm stainless steel 316L.

Part No.: 82-6651.2114

Technical data



| | |
|---------------------------|-------------------------------|
| Front form | round |
| Mounting cut-out | Ø 22.3 mm |
| Terminal | Plug-in terminal |
| Shape of illumination | Ring (Tritan) |
| Operating voltage | 24 V DC (LED) |
| Lens illumination | illuminative |
| Lens colour | Silver |
| Lens shape | flush |
| Lens material | Stainless steel 316L |
| Lens optics | opaque |
| Front bezel shape | flush |
| Front bezel material | Stainless steel 316L |
| Weight | 0.018 kg |
| IP front protection | IP65, IP67 |
| Contacts change over | 1 C |
| Contact material | Silver |
| Illumination colour | Red |
| Kind of illumination | Single-LED |
| Switching action | Maintained |
| Switching voltage | 36 V |
| Switching voltage kind of | AC/DC |
| Switching current | 0.6 A |
| Switching system | Snap-action switching element |

- Hints
- Switching voltage: max. 36 V AC/1A, max. 36 V DC/0.6

Dimensions

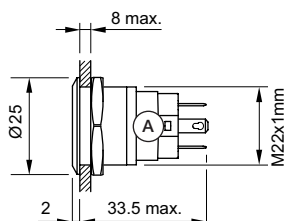

Mounting cut-outs

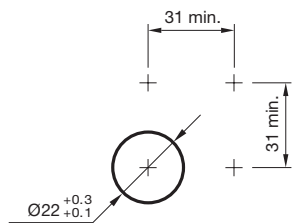

Wiring diagrams

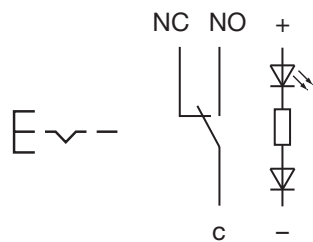

Component layouts

