

25

P 303

## Modular connectors



Modular plug, 10p10c (RJ50), with locking latch, piercing technology

25

P 303

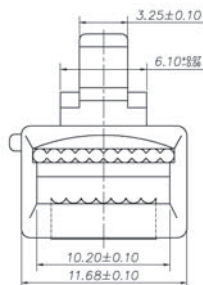
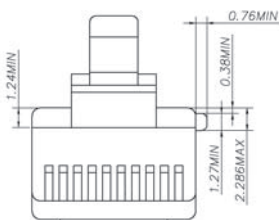
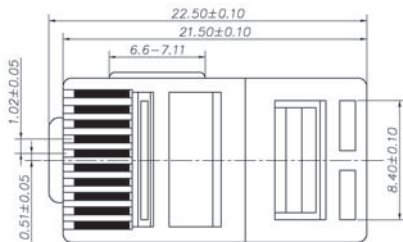
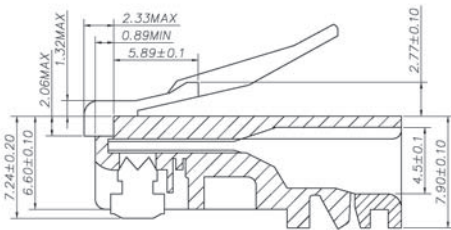

#### Materials

|                 |                       |
|-----------------|-----------------------|
| Insulating body | PC                    |
| Contact         | Cu alloy, gold-plated |

#### Connectable conductors for piercing area

|              |             |
|--------------|-------------|
| Construction | round cable |
|--------------|-------------|

#### Electrical data (at T<sub>amb</sub> 20 °C)

|                       |        |
|-----------------------|--------|
| Rated current         | ≤ 2 A  |
| Rated voltage         | 250 V  |
| Insulation resistance | 500 MΩ |

#### Associated products

Counterparts

25

P 303

---

Accessories

☞ 2532 01

☞ 2532 01

Harnessing equipment

☞ ZP25-3

---

25

P 303

| Designation | Pole Number | PU (Pieces) | MDQ (Pieces) |
|-------------|-------------|-------------|--------------|
| P 303       | 10          | 100         | 1000         |

**Packaging:**

in bulk, in a cardboard box or a plastic bag