

# 15SRB8 ✓ ACTIVE

Corcom | Corcom SRB

TE Internal #: 1-6609987-8

Corcom SRB, Multi-Function Inlet Filters, Power Line, Vertical,  
Leakage Current (Max) (120VAC, 60Hz) 2  $\mu$ A, Leakage Current (Max)  
(250VAC, 50Hz) 5  $\mu$ A

[View on TE.com >](#)



EMI Filters > Multi-Function Inlet Filters > CORCOM SRB SERIES IEC FILTERED INLETS

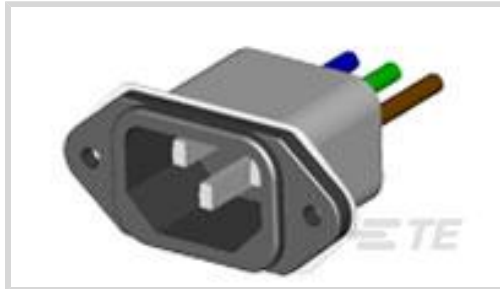

Filter Type: **Power Line**

Mount Angle: **Vertical**

Leakage Current (Max) (120VAC, 60Hz): **2  $\mu$ A**

Leakage Current (Max) (250VAC, 50Hz): **5  $\mu$ A**

Filter Current Rating: **15 A**

[All CORCOM SRB SERIES IEC FILTERED INLETS \(71\)](#)

## Features

### Product Type Features

Ground Choke Option	No
Ground Option	None
Filter Type	Power Line
Filtering Requirements	Unfiltered
Filter Connector Type	IEC 60320-1 C-14

### Electrical Characteristics

Leakage Current (Max) (120VAC, 60Hz)	2 $\mu$ A
Leakage Current (Max) (250VAC, 50Hz)	5 $\mu$ A
Filter Current Rating	15 A
Voltage Rating (Max)	250 VAC

### Mechanical Attachment

Mount Angle	Vertical
Filter Mount Style	Flanged

### Usage Conditions

Operating Temperature Range	-10 – 40 °C
-----------------------------	-------------

### Other

--	--



Comment	Small footprint. VDE rated at 10 amps.
---------	--

### Product Compliance

[For compliance documentation, visit the product page on TE.com>](#)

EU RoHS Directive 2011/65/EU	Compliant
EU ELV Directive 2000/53/EC	Compliant
China RoHS 2 Directive MIIT Order No 32, 2016	No Restricted Materials Above Threshold
EU REACH Regulation (EC) No. 1907/2006	Current ECHA Candidate List: JAN 2021 (211) Candidate List Declared Against: JAN 2021 (211) Does not contain REACH SVHC
Halogen Content	Low Halogen - Br, Cl, F, I < 900 ppm per homogenous material. Also BFR/CFR/PVC Free
Solder Process Capability	Not applicable for solder process capability

#### Product Compliance Disclaimer

This information is provided based on reasonable inquiry of our suppliers and represents our current actual knowledge based on the information they provided. This information is subject to change. The part numbers that TE has identified as EU RoHS compliant have a maximum concentration of 0.1% by weight in homogenous materials for lead, hexavalent chromium, mercury, PBB, PBDE, DBP, BBP, DEHP, DIBP, and 0.01% for cadmium, or qualify for an exemption to these limits as defined in the Annexes of Directive 2011/65/EU (RoHS2). Finished electrical and electronic equipment products will be CE marked as required by Directive 2011/65/EU. Components may not be CE marked. Additionally, the part numbers that TE has identified as EU ELV compliant have a maximum concentration of 0.1% by weight in homogenous materials for lead, hexavalent chromium, and mercury, and 0.01% for cadmium, or qualify for an exemption to these limits as defined in the Annexes of Directive 2000/53/EC (ELV). Regarding the REACH Regulation, the information TE provides on SVHC in articles for this part number is based on the latest European Chemicals Agency (ECHA) 'Guidance on requirements for substances in articles' posted at this URL: <https://echa.europa.eu/guidance-documents/guidance-on-reach>

### Compatible Parts

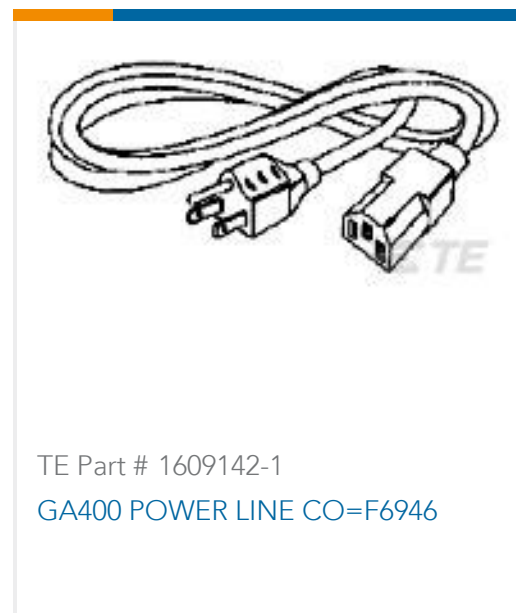

### Also in the Series | Corcom SRB



Multi-Function Inlet Filters(78)

## Customers Also Bought



TE Part #1-6609987-4  
CORCOM SRB SERIES IEC FILTERED  
INLETS



TE Part #1-1609112-3  
15CBS1=F8273



TE Part #1-1546306-6  
16P.374" DR BARRIER STRIP



TE Part #1419106-1  
27E006=SOCKET,KH,14,SLG,G/T,PH



TE Part #11027887-00  
BL CLS 1, 12'SENSOR/100' CABLE



TE Part #1744417-7  
7 POS EP 2.5 HSG, GLOW WIRE



TE Part #1137553001  
55A1121-26-0/9-9



TE Part #R-8656  
RTD,STRR,P100,385,.5%,.030T,H

## Documents

### Product Drawings

[15SRB8=F8220H](#)

English

### CAD Files

Customer View Model

[ENG\\_CVM\\_CVM\\_1-6609987-8\\_D.2d\\_dxf.zip](#)

English

[3D PDF](#)

3D

Customer View Model

[ENG\\_CVM\\_CVM\\_1-6609987-8\\_D.3d\\_igs.zip](#)

English

Customer View Model

[ENG\\_CVM\\_CVM\\_1-6609987-8\\_D.3d\\_stp.zip](#)

English

By downloading the CAD file I accept and agree to the [Terms and Conditions](#) of use.



---

**Datasheets & Catalog Pages**

[1654001\\_CORCOM\\_PRODUCT\\_GUIDE](#)

English

[1654001\\_CORCOM\\_PRODUCT\\_GUIDE\\_SRB\\_SERIES](#)

English

**Corcom Combined Selector Charts**

English

[1-1654250-1\\_CORCOM\\_EMI\\_RFI\\_QRG](#)

English

---

**Agency Approvals**

[UL Report](#)

English