

EAO – Your Expert Partner for Human Machine Interfaces

82-4551.1113 - Illuminated pushbutton 16 mm Aluminium, momentary

82-4551.1113 - Illuminated pushbutton 16 mm Aluminium, momentary



Attention: The preview is based on a sample product. This can differ from your current configuration.

Mounting

Design	flush
Mounting cut-out	Ø 16 mm

Front

Front shape	round
Front ring shape	flush
Front dimension	Ø 18 mm
Front bezel material	Aluminium

Other Attributes

Operating voltage	12 V AC/DC
Weight	0,018 kg
Operation current	7 mA

Operating-/Indication part

Lens optics	opaque
Lens material	Aluminium
Lens profile	flat
Lens illumination	illuminative
Lens colour	natural anodized

IP-Rating

Front protection	IP65, IP67
------------------	------------

Connection Method

Terminal	Solder 2.8 x 0.5 mm
----------	---------------------

Actuator

Switching action	Momentary
------------------	-----------

Switching element

Switching current	3 A
Contact material	Silver
Contacts	1 C
Switching system	Snap-action switching element
Switching voltage	240 V AC/DC

Illumination

Illumination	Ring with red LED
--------------	-------------------

Function

Illuminated pushbutton

EAO – Your Expert Partner for Human Machine Interfaces

82-4551.1113 - Illuminated pushbutton 16 mm Aluminium, momentary

Dimensions

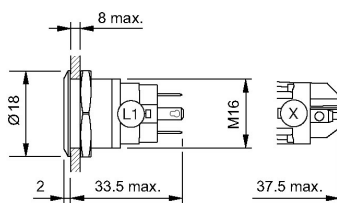

Mounting cut-outs

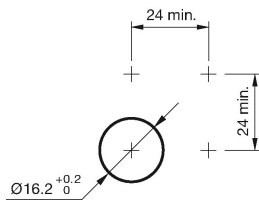

Wiring diagram

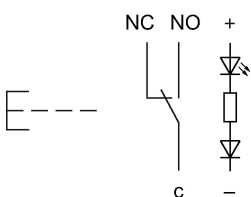

Component layout



Legend

Switching action: B = Momentary

Contacts: C = Changeover