

S.230 | 1/2" to 3/8" coupler



Standards:
NF ISO 3316, ISO 3316, DIN
3123, ASME B107.10

Description:

- 1/2" to 3/8" coupler

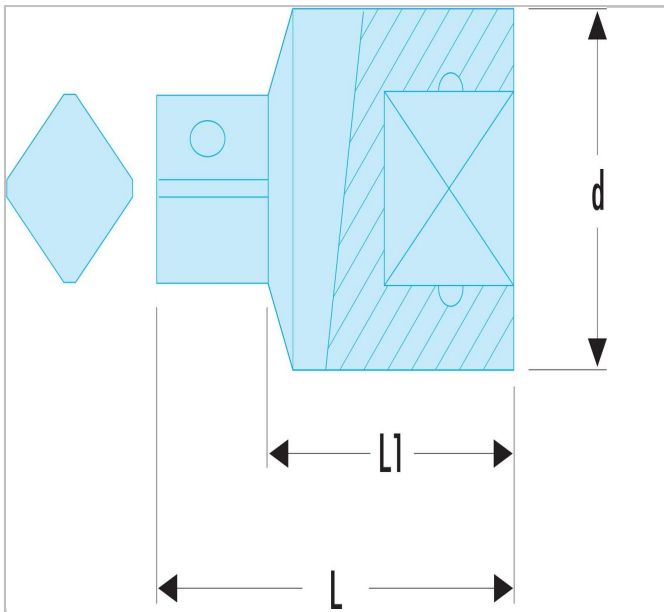

 S.230	
Diameter [mm]	23.0
Length L [mm]	33.5
Weight [g]	55.0
Length L1 [mm]	23