

Dynatork 1 Aluminium

Key Data: Dynatork 1 Motor Ref: 970.15.A

Speed range	200 - 800 rpm	
Torque at 200 rpm / 6.9 bar (100 psi)	2.79 Nm	
Torque at 800 rpm / 6.9 bar (100 psi)	1.66 Nm	
Max air consumption 800 rpm / 6.9 bar	9.7 m ³ /h	
Shaft Diameter	10 mm	
Weight	1.5 kg	
Ports	1/8" BSP	
Lubrication	Non-Lube: for use with a dry, clean, non-lubricated air supply (can be used in lubricated system)	

Performance

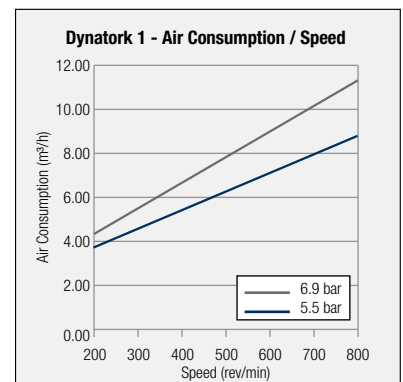
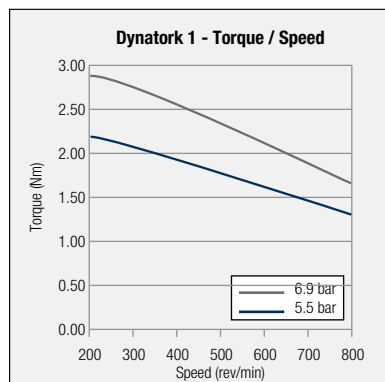
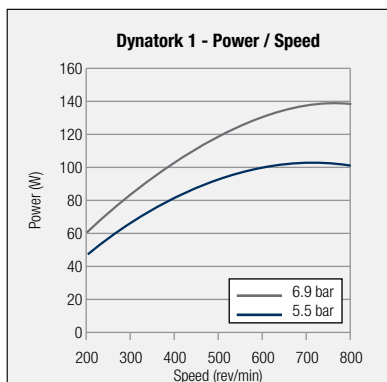

Body Mounting

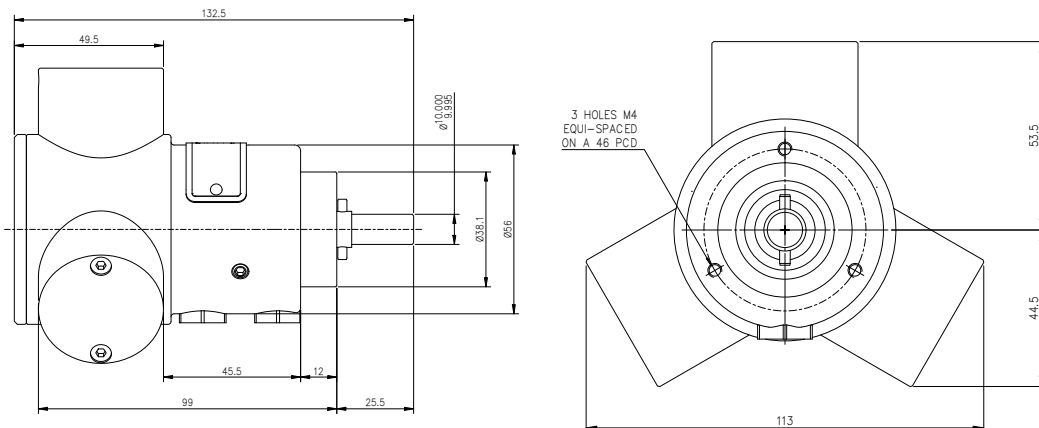

For alternative mounting option, see page 23