

Double Pole RCD

Features



- Protection against earth fault/leakage current and residual current, function of isolation
- Protection against fire hazard caused by Insulation faults
- Residual fault current Indication
- 6kA high breaking capacity
- Pin/fork type bus bar terminal connection
- Fire resistant plastic parts withstand abnormal heating and strong Impact
- Automatically disconnect the circuit when earth fault/leakage current occurs or exceeds the rated sensitivity
- Independent of power supply and line voltage, and free from external interference, voltage fluctuation
- 35mm DIN rail mounting
- IEC61008, EN61008

Specifications

Voltage Rating	: 230V AC
Rated Residual Current	: 30mA, 100mA, 300mA
Number of poles	: 1P+N (2P)
Rated Short Circuit	: 6kA
Rated frequency	: 50/60Hz
Max. Back Up Fuse	: In=16-63A 63AGg/gl In=80A 80AGg/gl
Electrical Endurance	: 10000 Cycles
Mechanical Endurance	: 20000 Cycles
Terminals	: Pillar Type
Cable Termination	: 35mm ²
Torque of Screw	: 2.5Nm
IP Degree	: IP20

Diagram

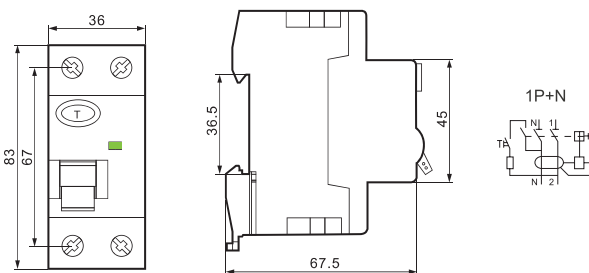

Dimensions : Millimetres

Part Number Table

Description	Part Number
40A Double Pole RCD	AUR1-40A
63A Double Pole RCD	AUR1-63A
80A Double Pole RCD	AUR1-80

Important Notice : This data sheet and its contents (the "Information") belong to the members of the AVNET group of companies (the "Group") or are licensed to it. No licence is granted for the use of it other than for information purposes in connection with the products to which it relates. No licence of any intellectual property rights is granted. The Information is subject to change without notice and replaces all data sheets previously supplied. The Information supplied is believed to be accurate but the Group assumes no responsibility for its accuracy or completeness, any error in or omission from it or for any use made of it. Users of this data sheet should check for themselves the Information and the suitability of the products for their purpose and not make any assumptions based on information included or omitted. Liability for loss or damage resulting from any reliance on the Information or use of it (including liability resulting from negligence or where the Group was aware of the possibility of such loss or damage arising) is excluded. This will not operate to limit or restrict the Group's liability for death or personal injury resulting from its negligence. pro-ELEC is the registered trademark of Premier Farnell Limited 2019.