

Specifications

ABI-001-RC

Rated voltage	12VDC
Operating voltage	3~16VDC
Rated current*	≤7mA
Sound output at 10cm*	≥80dB
Resonant frequency	4000±500Hz
Tone	Continuous
Operating temperature	-20~+70°C
Storage temperature	-30~+80°C
Weight	1g

*Value applying at rated voltage (DC)

Features

- ROHS compliant
- Black in colour
- With internal drive circuit
- Low power consumption
- Wave solderable and washable
- Housing material: Noryl
- PCB mountable
- Sealed base

All data at 25°C unless otherwise specified

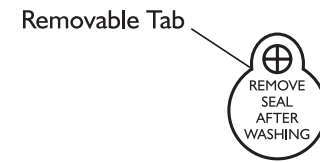
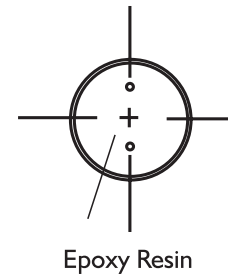
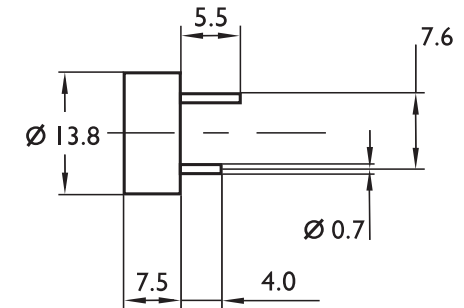
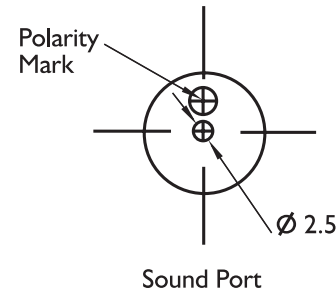

Dimensions Unit: mm Tolerance: ±0.5mm



ALAN BUTCHER COMPONENTS LTD

Alan Butcher Components Ltd

Unit 1 Beechwood Clump Farm Industrial Estate Tin Pot Lane Blandford Dorset DT11 7TD

Telephone 01258 456360 Facsimile 01258 459194 Email sales@abcomponents.co.uk

www.abcomponents.co.uk