

DURATOOL



Butane Safety Gas Torch
Model: D03354

IMPORTANT SAFETY INFORMATION

- Never point the tool towards yourself or towards others when lighting or during use.
- Do not touch the tip, nozzle or the main tube when hot.
- Contains flammable gas contents under pressure.
- Do not expose to sparks or naked flame.
- Do not puncture or incinerate the unit.
- Store at temperatures below 48°C (120°F)
- Use only in a well ventilated area.
- This appliance is not intended for use by persons (including children) who are not mentally able, physically capable, experienced or do not understand the product. They should be given supervision and instruction in the use of the appliance by a person responsible for their safety.
- Children should be supervised to ensure that they do not play with the appliance.
- There are no user serviceable parts inside, do not disassemble the unit.
- Ensure the flame is fully extinguished and the torch allowed to cool after use before putting into storage.

REFILLING

- Firmly insert the refill cannister nozzle into the filling valve under the base of the torch keeping it perpendicular at all times.
- Only use Butane refill gas.
- The torch will only take a few seconds to fill, then allow a couple of minutes for the gas to stabilise before using the torch.

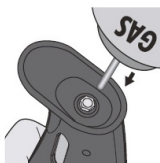

OPERATION

- Press and hold the safety button and press down the ignition button and the torch will light.

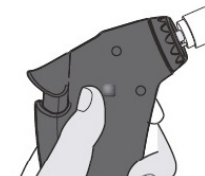

- For short duration use hold down the ignition button and release it when you want to extinguish the flame.

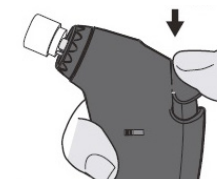

- To enable continuous use, while holding down the ignition button slide the hands free switch to the right.

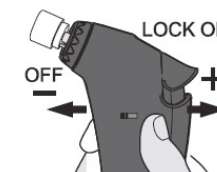

You can now release all buttons and the flame will continue to burn.

- To extinguish the flame slide the hands free switch to the left.

WARNING: if the flame has been lit the nozzle will be hot, so take extreme care.



SPECIFICATION

Weight	51g
Fuel	Butane (5.6ml)
Operating time	Approx 20 minutes
Dimensions (H x W x D)	105 x 60 x 27mm
Flame temperature	Up to 1300°C (blue flame)

Made in Taiwan
PR2 9PP
PO Box 13362 Dublin 2

Man Rev 1.1