

# Data sheet Pushbutton Ø 16 mm silver contact.

## Part No.: 82-4162.2000.B001

### Technical data



Terminal	Screw terminal
Operating Travel	ca. 3 mm
Lens illumination	non illuminative
Lens colour	Silver
Lens shape	raised
Lens material	Stainless steel
Lens optics	opaque
Front bezel shape	flush
Front bezel material	Stainless steel
Weight	0.02 kg
Contact material	Silver
Switching action	Maintained
Switching system	Snap-action switching element
Symbol	ON/OFF
Contacts	1 FS
Operating temperature	- 30 °C ... + 70 °C
Approbations	CB, CCC, C UL, UL
Operating force	4 ... 7 N
Climate resistance	Damp heat, 21 days according to IEC 60512-11

### Dimensions

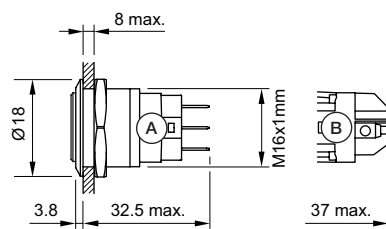

A = Solder terminal  
B = Screw terminal

### Mounting cut-outs

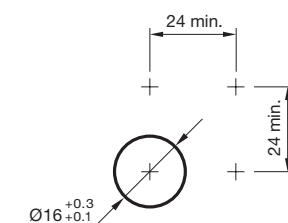

## Wiring diagrams

---

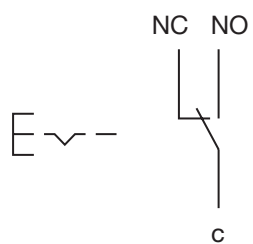

## Component layouts

---

