

# 4-type Ferrule Kit

**multicomp** PRO



## Description

The product is a 4-type Ferrule Kit made of nylon insulation and copper tube connector with tin-plated surface treatment.

### Ferrule 1

#### Specifications

Max. Electric Current	: <table border="1" style="display: inline-table; vertical-align: middle;"><tr><td>AWG</td><td>8</td></tr><tr><td>Amperes</td><td>70</td></tr></table>	AWG	8	Amperes	70
AWG	8				
Amperes	70				
Max. Electrical Rating	: 105°C, 600V				
Insulation Material	: Nylon				
Insulation colour	: French colour : Brown German colour : Ivory Din colour : Red				
Connector material	: Copper tube				
Wire range	: 8AWG (10mm <sup>2</sup> )				
Connector surface treatment	: Tin plated				

#### Diagram

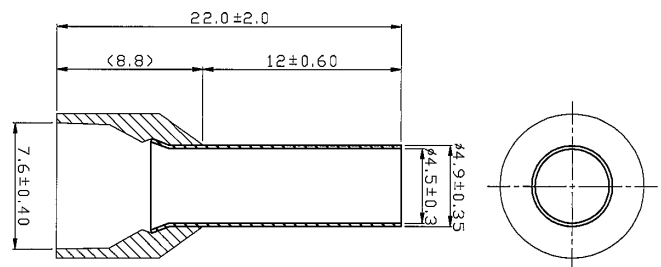

### Ferrule 2

#### Specifications

Max. Electric Current	: <table border="1" style="display: inline-table; vertical-align: middle;"><tr><td>AWG</td><td>6</td></tr><tr><td>Amperes</td><td>95</td></tr></table>	AWG	6	Amperes	95
AWG	6				
Amperes	95				
Max. Electrical Rating	: 105°C, 600V				
Insulation Material	: Nylon				
Insulation colour	: French colour : Ivory German colour : Green Din colour : Blue				
Connector material	: Copper tube				
Wire range	: 6AWG (16mm <sup>2</sup> )				
Connector surface treatment	: Tin plated				

#### Diagram

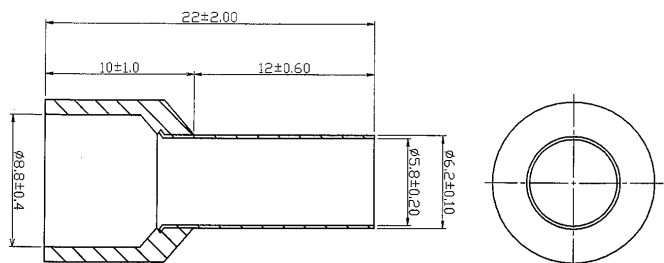

### Ferrule 3

#### Specifications

Max. Electric Current	: <table border="1" style="display: inline-table; vertical-align: middle;"><tr><td>AWG</td><td>12</td></tr><tr><td>Amperes</td><td>35</td></tr></table>	AWG	12	Amperes	35
AWG	12				
Amperes	35				
Max. Electrical Rating	: 105°C, 600V				
Insulation Material	: Nylon				
Insulation colour	: French colour : Orange German colour : Grey Din colour : Grey				
Connector material	: Copper tube				
Wire range	: 12AWG (4mm <sup>2</sup> )				
Connector surface treatment	: Tin plated				

#### Diagram

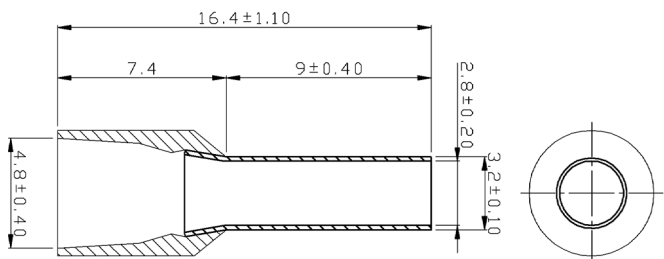

Dimensions : Millimetres

Newark.com/multicomp-pro  
Farnell.com/multicomp-pro  
sg.element14.com/b/multicomp-pro

**multicomp** PRO

# 4-type Ferrule Kit

## Ferrule 4

### Specifications

Max. Electric Current	:	AWG		10
		Amperes		50
Max. Electrical Rating	:	: 105°C, 600V		
Insulation Material	:	: Nylon		
Insulation colour	:	: French colour : Green		
		: German colour : Black		
		: Din colour : Yellow		
Connector material	:	: Copper tube		
Wire range	:	: 10AWG (6mm <sup>2</sup> )		
Connector surface treatment	:	: Tin plated		

### Diagram

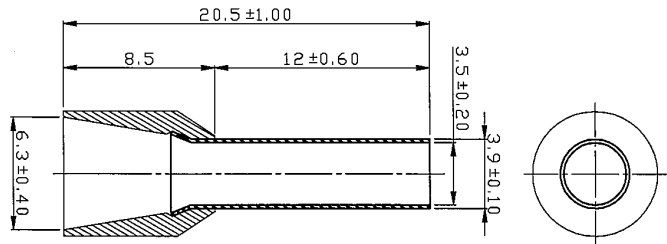

### Part Number Table

Description	Part Number
Terminals & Splices, 4 Types of 4mm <sup>2</sup> to 16mm <sup>2</sup> Ferrules	XRBOX4-E-EA481

Dimensions : Millimetres

**Important Notice :** This data sheet and its contents (the "Information") belong to the members of the AVNET group of companies (the "Group") or are licensed to it. No licence is granted for the use of it other than for information purposes in connection with the products to which it relates. No licence of any intellectual property rights is granted. The Information is subject to change without notice and replaces all data sheets previously supplied. The Information supplied is believed to be accurate but the Group assumes no responsibility for its accuracy or completeness, any error in or omission from it or for any use made of it. Users of this data sheet should check for themselves the Information and the suitability of the products for their purpose and not make any assumptions based on information included or omitted. Liability for loss or damage resulting from any reliance on the Information or use of it (including liability resulting from negligence or where the Group was aware of the possibility of such loss or damage arising) is excluded. This will not operate to limit or restrict the Group's liability for death or personal injury resulting from its negligence. Multicomp Pro is the registered trademark of Premier Farnell Limited 2019.