Desktop Mounting Kit for CompactDAQ Getting Started

Contents

Intro Topic.....	3
Installing the NI 9901 on a Chassis.....	4
Installing the Adapter Bracket.....	4
Installing the Mounting Bracket.....	5
Environmental Management.....	7
Waste Electrical and Electronic Equipment (WEEE).....	7
电子信息产品污染控制管理办法(中国 RoHS).....	7
Worldwide Support and Services.....	7

Intro Topic

Use the NI 9901 desktop mounting kit to mount a CompactRIO or CompactDAQ chassis on a desktop.

What You Need to Get Started

You will need the following tools to install the NI 9901.

- #1 Phillips screwdriver
- #2 Phillips screwdriver
- T-10 Torx screwdriver (for use with cRIO-905x controllers)

Kit Contents

Verify that the following items are included in the NI 9901 kit.

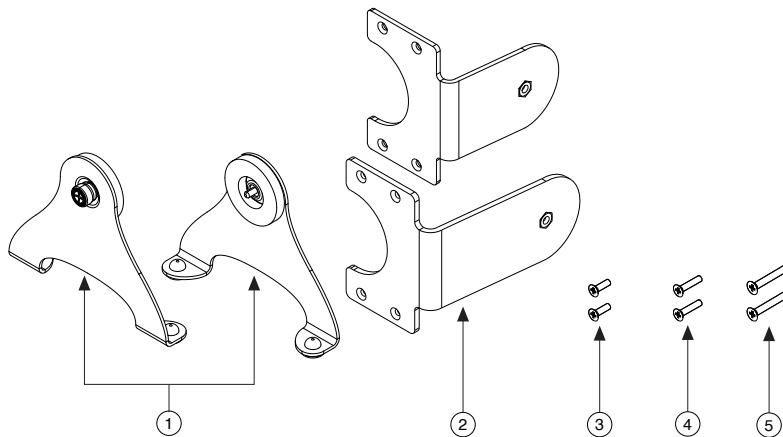

1. NI 9901 end bracket (x2)
2. NI 9901 adapter bracket (x2)
3. M3 x 14 screw (x2)
4. M3 x 20 screw (x2)
5. M3 x 35 screw (x2)



Note The kit contains two sizes of adapter brackets. Determine which adapter bracket length is appropriate for your chassis before installation.

Installing the Adapter Bracket

If you are installing the NI 9901 on a chassis that does not provide mounting holes at both ends of the chassis, you must install the adapter bracket on the back of the chassis.

What to Use

- Adapter bracket appropriate for your chassis
- M3 screws appropriate for your chassis
- Screwdriver, #1 Phillips or T-10 Torx, depending on your chassis, user-provided

What to Do

Follow these steps to mount the adapter bracket on the chassis.



Note You must use the screws provided with the NI desktop mounting kit because they are the correct depth and thread for the panel mounting plate. Refer to the chassis documentation to determine the correct screw size.

Figure 1. Installing the Adapter Bracket

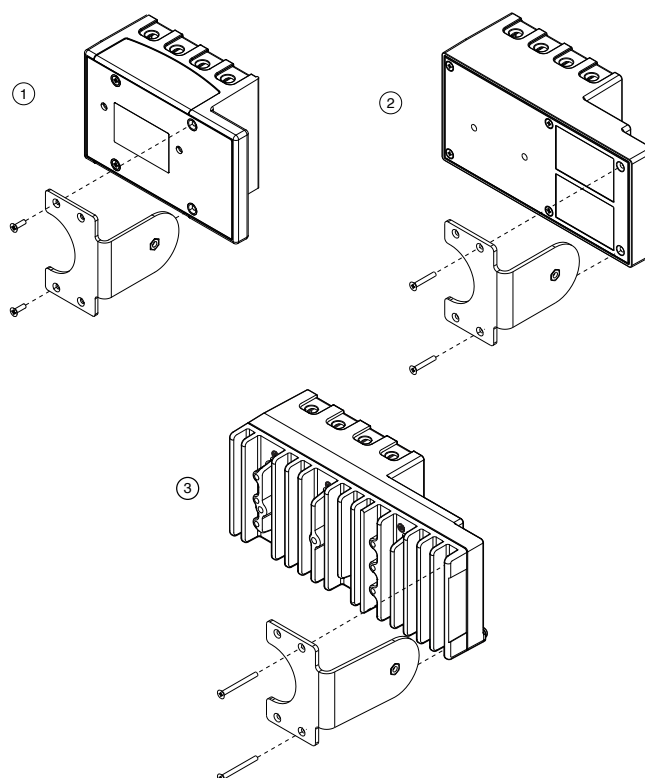

1. R Series expansion chassis
2. cDAQ and cRIO chassis
3. cRIO-905x chassis

1. Use the #1 Phillips or the T-10 Torx screwdriver to remove the two screws from the back of the chassis on the controller side.
2. Use the #1 Phillips screwdriver and the two M3 screws to attach the adapter bracket to the chassis.



Note Tighten the screws to a maximum torque of 0.55 N · m (4.9 lb · in.).

Installing the Mounting Bracket

What to Use

- Mounting bracket
- Screwdriver, #2 Phillips, user-provided

What to Do

Follow these steps to attach the mounting bracket on the chassis.

Figure 2. Installing the Mounting Bracket

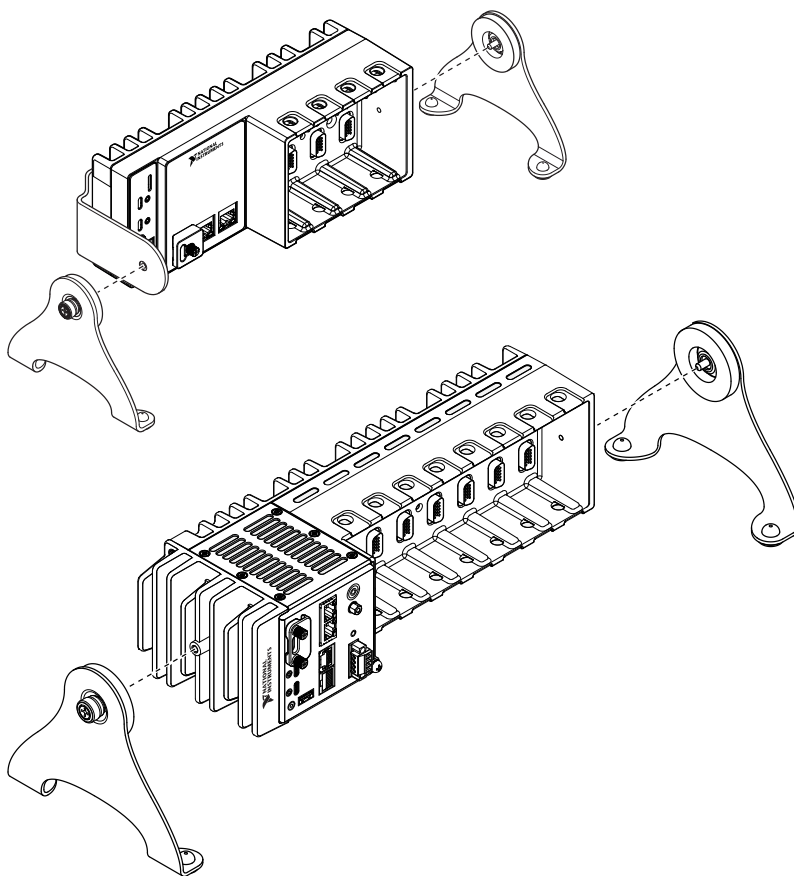

1. Align the mounting brackets with the mounting holes at the end of the chassis or on the adapter bracket.

2. Use the #2 Phillips screwdriver to tighten the captive screw on the end bracket.

Environmental Management

NI is committed to designing and manufacturing products in an environmentally responsible manner. NI recognizes that eliminating certain hazardous substances from our products is beneficial to the environment and to NI customers.

For additional environmental information, refer to the **Minimize Our Environmental Impact** web page at ni.com/environment. This page contains the environmental regulations and directives with which NI complies, as well as other environmental information not included in this document.

Waste Electrical and Electronic Equipment (WEEE)

EU Customers At the end of the product life cycle, all NI products must be disposed of according to local laws and regulations. For more information about how to recycle NI products in your region, visit ni.com/environment/weee.

电子信息产品污染控制管理办法 (中国 RoHS)

中国客户 National Instruments 符合中国电子信息产品中限制使用某些有害物质指令(RoHS)。关于 National Instruments 中国 RoHS 合规性信息，请登录 ni.com/environment/rohs_china。(For information about China RoHS compliance, go to ni.com/environment/rohs_china.)

Worldwide Support and Services

The NI website is your complete resource for technical support. At ni.com/support, you have access to everything from troubleshooting and application development self-help resources to email and phone assistance from NI Application Engineers.

Visit ni.com/services for information about the services NI offers.

Visit ni.com/register to register your NI product. Product registration facilitates technical support and ensures that you receive important information updates from NI.

NI corporate headquarters is located at 11500 North Mopac Expressway, Austin, Texas, 78759-3504. NI also has offices located around the world. For support in the United States, create your service request at ni.com/support or dial 1 866 ASK MYNI (275 6964). For support outside the United States, visit the **Worldwide Offices** section of ni.com/niglobal to access the branch office websites, which provide up-to-date contact information.