

CABLE INSTRUCTION

Connector Body

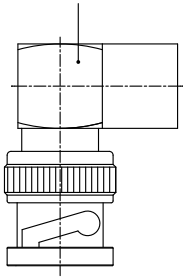

Braid Clamp



Washer

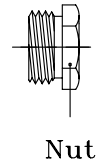
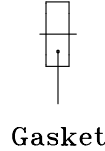
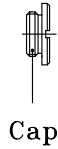

1.

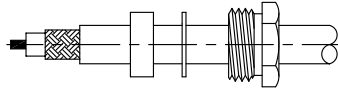

1. Preparation of Cable

- (1) Slide coupling nut onto cable
- (2) Strip cable to recommended dimensions shown in catalogue

2.

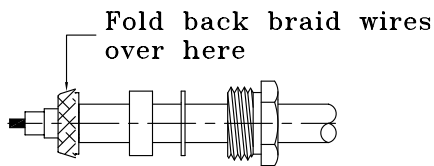

2. Installing Braid Clamp

- (1) Slide braid clamp until seat against cable jacket
- (2) Fold back braid wires to cover on outside of braid clamp

3.

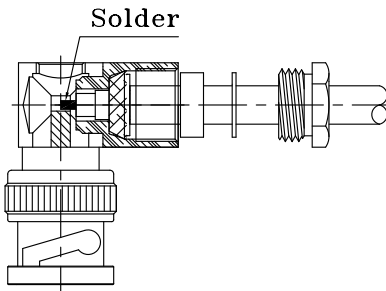

3. Soldering Center Contact to Cable Center Conductor

- (1) Insert cable into rear of connector body
- (2) Position cable center conductor in center contact slot
- (3) Solder center contact to cable center conductor

4.

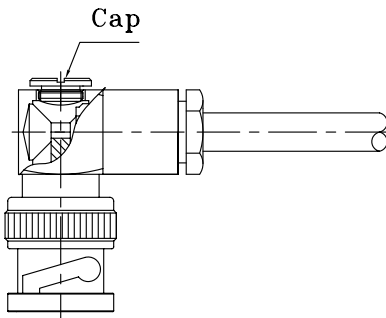

4. Final Assembly

- (1) Screw and tighten on nut
- (2) Screw and tighten cap into opening in rear of connector body

製圖	DRAWN	品名	Right-angle clamp type Contact	單位	MM	比例	SCALE	TOLERANCE	
	Yoko			TITLE			UNIT		
認定	APPROVAL	編號	13-06-4 58U	版次	A-0	日期	DATE	.X	±0.5
	Jenny	NO.		REV.			06.22.09	.XX	±0.3