



# 18 Element High Gain Outdoor TV Aerial

27881V User Guide



5G & 4G  
tuned

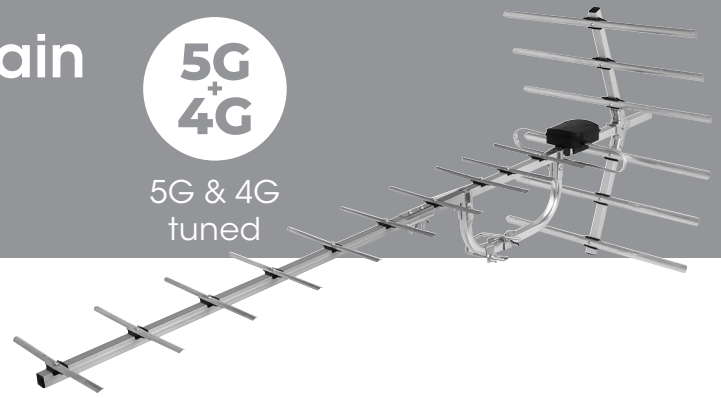

Congratulations on the purchase of your high gain Yagi TV aerial. The aerial is ideal for the reception of all available signals in medium and weak signal areas.

- Tuned to prevent interference from 5G/4G mobile signals
- Easy to assemble and connect
- Receives all available UHF, DVB-T and DVB-T2 frequencies
- Connection: saddle clamp

## General Safety Precautions

Do not undertake work outdoors at height unless you are competent in the use of ladders and other access equipment. Always use correct equipment, observe appropriate safety precautions and follow manufacturers instructions. If in doubt consult a professional installer.

Before starting installation check structure is sound and check for hidden wiring or plumbing.

When working on an installation outside, beware of overhead power lines. Observe safe working practices, tread carefully on roofs and ensure adequate lighting is available if working in loft or roof space.

Before making any connections switch electricity off at the mains.

To avoid injury always route cables or wiring carefully. Ensure cable is correctly routed before fixing into position, taking care not to overtighten cable clips.

This kit contains small parts - keep out of reach of children.

After installation make regular maintenance checks for wear and tear.

## Aerial assembly

- A** Slide the the balun and dipole assembly **7** onto the back of the boom **3** clip the balun onto the boom making sure the stud on the base of the balun locates in the hole on the top of the boom as shown.

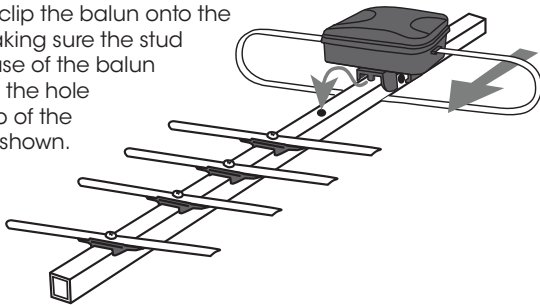

- B** Join the front and back parts of the boom **1** & **3** using the joining bracket **2**. Attach the centre mount bracket **5** to the boom in the position shown using the clips and bolts supplied.

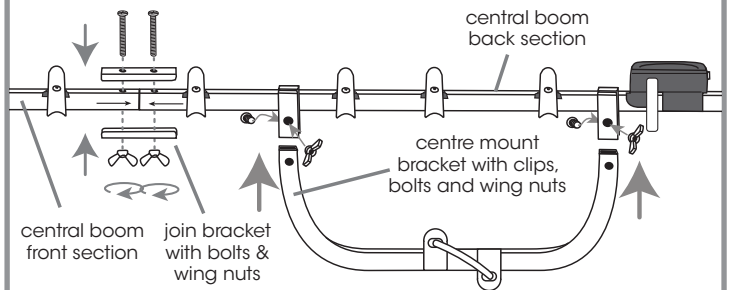

- C** Attach the reflectors **8** to the back of the boom **3** using the reflector clamps, bolt and wing nut **4**. Check that the reflector clamp tabs engage in the locating holes on the reflectors.

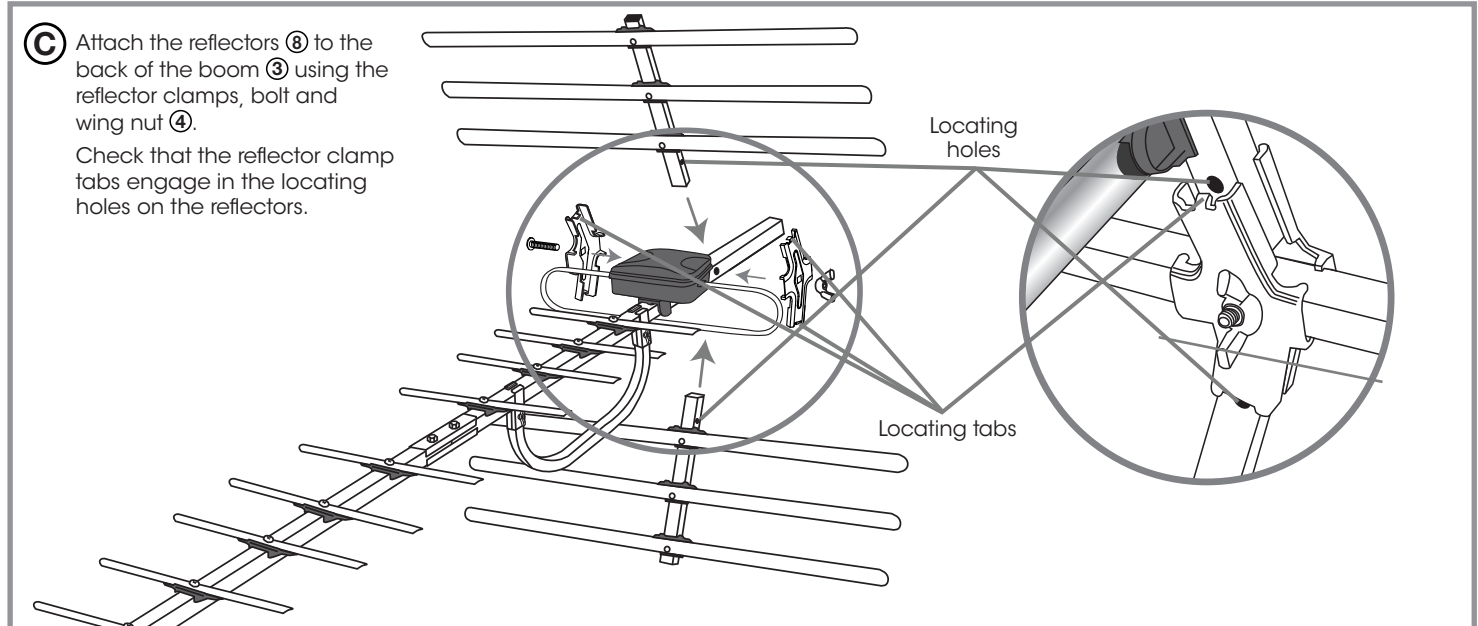

## Installation

For best results the aerial should be mounted on an outdoor aerial mast and pointed in the direction of the nearest transmitter\* making sure it is in a position where the transmitter signal will not be obstructed by nearby trees and buildings. If you are in any doubt about the direction in which the aerial should be pointing or the orientation of the aerial (horizontal for main transmitter, vertical for relay transmitter) check your neighbours' aerials. If mounting on an existing mast check that the mast is in good condition and firmly fixed.

Prepare cable and connect to the balun ⑦ as shown in Fig. D & E

1. Before preparing and stripping the cable ready for connection, pull off the balun cover and feed the coaxial cable through the hole in the balun casing cover.
2. Prepare cable as shown in Fig. D.
3. Feed the prepared cable through the braid clamp and thread the centre wire through the hole in the central terminal as shown in Fig. E. Clamp the cable braid securely first, then tighten the screw on the central terminal. Trim any stray braid that might come into contact with the centre wire or central terminal.
4. Replace the balun cover carefully and securely, making sure that the cable is not trapped or kinked. (Fig. D & E).

After the aerial direction has been fine tuned for best reception tighten the nuts on the V-Bolt ⑥ holding the mast clamp ⑨ and centre mount bracket ⑤ until the aerial is securely fixed to the mast.

The other end of the downlead can be terminated with a coax plug (not supplied) or connected to a suitable interior wall outlet.

## Troubleshooting

**No picture:**

Check all the connections from aerial to TV.

**Poor picture:**

Check all the connections from aerial to TV.

Check aerial is properly aligned to the correct transmitter.

If the aerial has been loft mounted try mounting outside.

Make sure new digital coax cable has been used throughout the installation.

Check the transmitter signal is not obstructed by nearby trees or buildings.

If in a very weak signal area or for long cable runs, installing a masthead amplifier will improve the signal.

If in a strong signal area the signal strength may need to be reduced by fitting an attenuator.

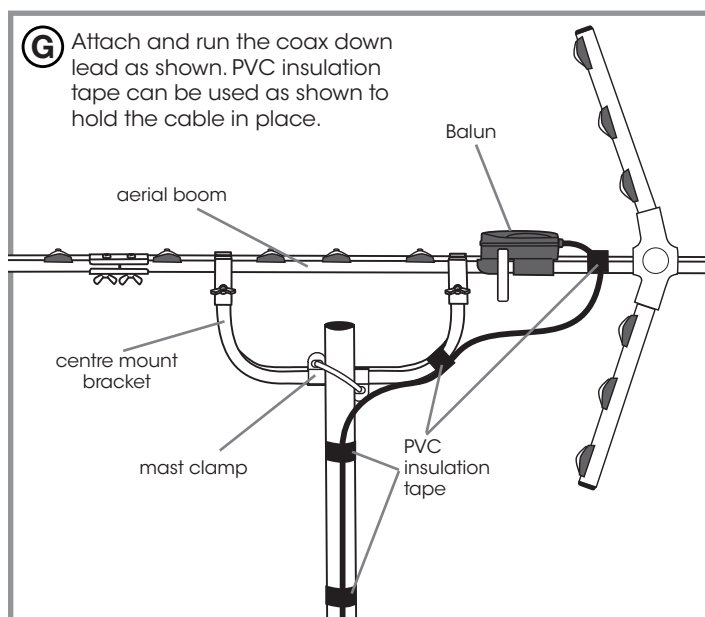
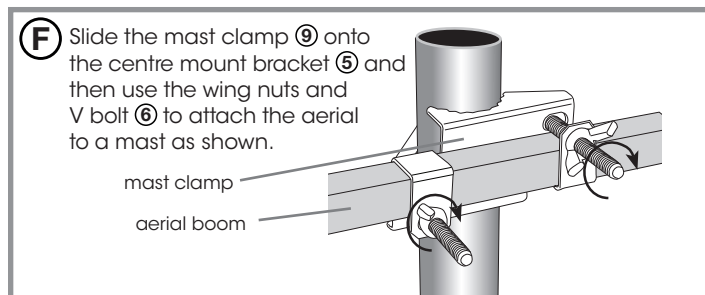
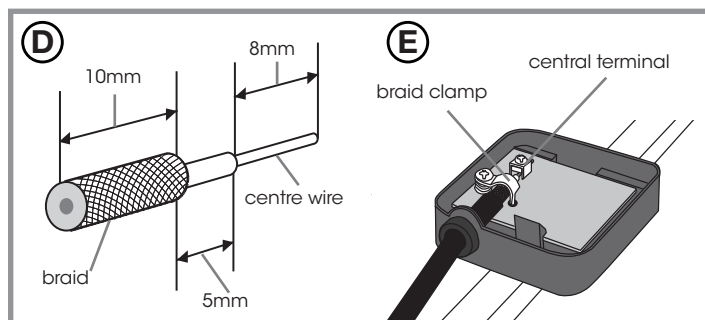

PLEASE NOTE: A coax plug is not included with this aerial. If you need to fit one please follow the wiring instructions shown below.

Specifications	
Frequency Range MHz	470-694
TV Channels	21-48
Forward Gain dBi	12
Front/Back Ratio dB	>15
Beam Width +/-deg.	H30°/V35°
Connector	Saddle and clamp
Length	1220mm
Width	380mm

For further information, please contact:

Technical Support: [www.philex.com/products/technical-support/](http://www.philex.com/products/technical-support/)

Other Useful Websites for Digital Advice:

\*To find out what DTT channels should be available locally and to find out where your nearest transmitter is (distance and compass bearing) visit: <http://www.wolfbane.net/cgi-bin/tvd.exe>

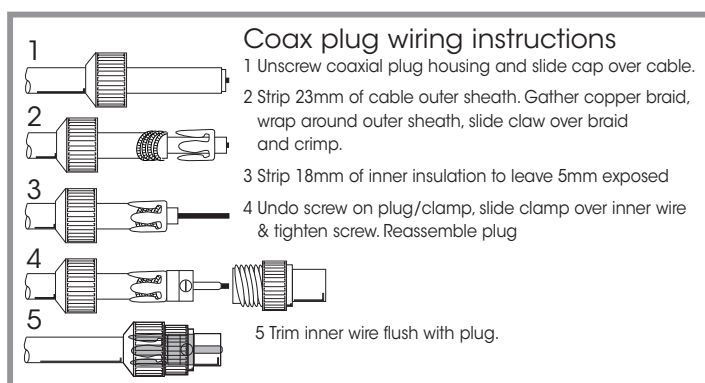

WEEE symbol. Waste electrical and electronic products should not be disposed of with household waste. Please recycle where facilities exist. Check with your Local Authority or local store for recycling advice.



UK Distributor  
Philex Electronic Ltd.  
Kingfisher Wharf, London Road,  
Bedford MK42 0NX,  
United Kingdom.

EU Distributor  
Philex Electronic Ireland Ltd.  
Robwyn House, Corrintra,  
Castleblayney, Co. Monaghan,  
A75 YX76, Ireland.



© Philex Electronic Ltd 2022. vb1.1