

Keystone adaptor 25x50mm, angled entry faceplate adapter

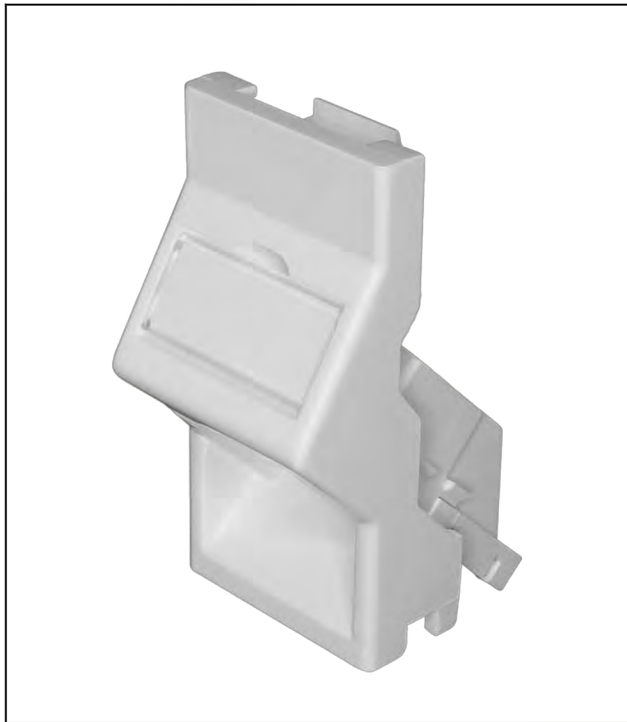

Keystone adaptor 25x50mm, angled entry, faceplate adapter (KA45whje)

These 25 x 50 angled adaptors have been designed for use with “Euro” 25 x 50 faceplates and have a built in sprung, sliding dustcover

Features:

- Angled modules minimize issues with bend radius and are suitable for use with shallow backboxes or larger keystones
 - Window and paper labelling facility
 - Not suitable for keystones which protrude beyond the faceplate, such as fibre, ‘F’ type, speaker and HDMI connectors
 - Fitted with a sprung, sliding shutter, which minimizes the effect of dust
-

Specifications:

- Net weight (including primary packaging): 8 g #20: 168g
- Dimensions: (including primary packaging) 25x50x40mm #20: 240x170x30mm
- Colour: White
- Materials: ABS UL 94-HB

Packaging: individually poly bagged then bagged in 20's

Commodity code: 85444920

EAN: 5055386507402

Country of Origin: China

Illustrative image

