

Data sheet Actuator.

Part No.: 01-262.0252

Technical data



Design	raised
Front form	rectangular
Front dimension	24 mm x 18 mm
Mounting cut-out	Ø 16 mm
Terminal	Soldering terminal
Operating Travel	ca. 3 mm
Lens illumination	illuminative
Front bezel colour	Black
Front bezel material	Plastic
Housing colour	Black
Housing material	Plastic
Weight	0.01 kg
IP Protection	IP40 front side, IP67 with front protective cap
Contact material	Gold
Switching action	Maintained
Switching system	Snap-action switching element
Switching rating	250 V @ 5 A
Internal size	18,8 mm x 12,8 mm
Contacts	2 NC / 2 NO
Operating temperature	- 25 °C ... + 55 °C, mounted as a block, make sure the heat can escape freely
Approbations	CB (IEC 61058-1), CSA, DNV, ENEC (EN 61058-1), UL
Operating force	2 N ... 5,5 N, depending on the number of switching elements
Climate resistance	Standard condition according to IEC 60068-2-3, Changing condition according to IEC 60068-2-14
Mechanical lifetime	1 Mio. cycles of operation
Tightening torque	Fixing nut max. 0.25 Nm

Dimension drawings

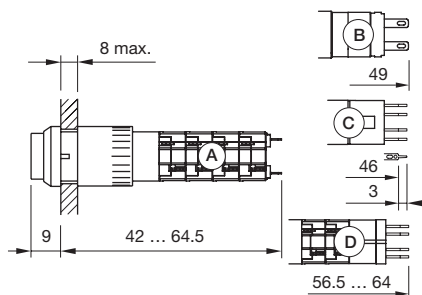

- A = Solder terminal
- B = Plug-in terminal 2.8 mm x 0.5 mm
- C = Universal terminal 2.0 mm x 0.5 mm
- D = Universal-Solder terminal

Mounting cut-outs

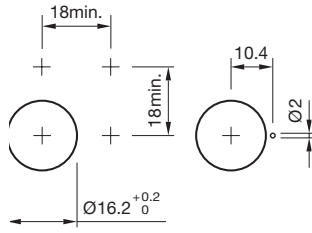

Wiring diagrams

