

PRO-ELEC



16" Metal Pedestal Fan

Model: PEL01936

Please read these instructions carefully before use and retain for future reference.

IMPORTANT SAFETY INFORMATION

- When using electrical appliances basic safety precautions should always be followed.
- Check that the voltage indicated on the rating plate corresponds with that of the local network before connecting the appliance to the mains power supply.
- This appliance is intended for domestic use only. It should not be used for commercial purposes.
- For indoor use only.
- This appliance can be used by children aged from 8 years and above and persons with reduced physical, sensory or mental capabilities or lack of experience and knowledge if they have been given supervision or instruction concerning the use of the appliance in a safe way and understands the hazards involved.
- Children shall not play with this appliance.
- Cleaning and maintenance shall not be made by children without supervision.
- There are no user-serviceable parts in this product. Refer servicing to qualified personnel.
- Do not operate this fan with a damaged plug or cord, after a malfunction or after being dropped or damaged in any way.
- If the supply cord is damaged, it must be replaced by the manufacturer, its service agent or similarly qualified persons in order to avoid a hazard.
- Ensure that the fan is switched off before removing the guard.
- Do not insert anything through the grille when the fan is in use.
- Make sure that the fan is on a stable surface when operating.
- It is recommended to unplug the fan from the mains socket when not in use.

PRODUCT OVERVIEW

- | | |
|---------------------------------|-------------------------------|
| 1. Front Guard | 11. Oscillating Control |
| 2. Locking screw | 12. Motor Spindle |
| 3. Fan Blade | 13. Fan Blade Retaining Screw |
| 4. Rear Guard | 14. Guard Retaining Clips |
| 5. Front Guard Nut | 15. Stand Base |
| 6. Telescopic Stand | 16. Weight |
| 7. Pivot Adjustment Thumb wheel | 17. Clamping Washer |
| 8. Pivot Screw | 18. Locking Screw |
| 9. Motor Housing | |
| 10. On/Off/Speed Control | |

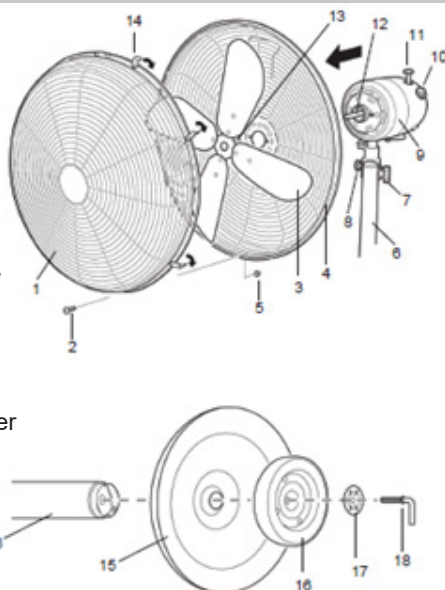

ASSEMBLY

- Assemble the stand by inserting the outer tube into the base, fit the weight and secure in place using the locking screw. Place the assembly upright.
- Place the motor housing on the top of the stand and thread the large pivot bolt through the bracket
- Screw in the small retaining screw and tighten (but do not over tighten).
- Fit the large pivot knob onto the end of the pivot bolt and lightly tighten.
- Screw in the tilt adjustment thumb wheel and tighten.
- If fitted remove the protective sleeve then slide the fan blade onto the shaft and fix into place with the locking screw on the centre boss.
- Remove the bolt and nut from the bottom of the front guard and rotate all clips to an open position.
- Attach the front fan guard, lining up the top notch with the rear guard and ensuring the bolt hole is aligned for the two halves.
- Close the clips and replace the nut and bolt locking the two halves together.

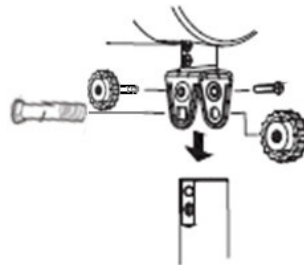

OPERATION

- Connect the mains plug to a suitable outlet.
- Select the desired speed using the speed control:
 - 0 = Off
 - 1 = Low speed
 - 2 = Medium speed
 - 3 = High speed
- Oscillation: In order to make the fan oscillate, push down the oscillation control. To stop the fan head from oscillating, pull up the oscillation control.
- The incline of the ventilator head can be adjusted by loosening the tilt adjustment thumb wheel and tilting it forwards or backwards.
- To adjust the height, slacken the height adjustment wheel, slide the upper section to the required height and re-tighten the adjustment wheel.

CLEANING & STORAGE

- Before cleaning, turn the fan off and unplug from the power supply.
- Use a soft cloth to wipe off any dust. If the fan is very dirty, use a damp cloth and wipe dry.
- Do not use any chemicals, abrasives or solvents that could damage the fan.

TECHNICAL SPECIFICATION

Power consumption	50W
Main voltage	220-240V~ 50Hz
Dimensions (HxWxD)	1230 x 448 x 400mm
Weight	6.4kg



INFORMATION ON WASTE DISPOSAL FOR CONSUMERS OF ELECTRICAL & ELECTRONIC EQUIPMENT.

When this product has reached the end of its life it must be treated as Waste Electrical & Electronic Equipment (WEEE). Any WEEE marked products must not be mixed with general household waste, but kept separate for the treatment, recovery and recycling of the materials used. Contact your local authority for details of recycling schemes in your area.



Made in China
PO Box 13362 Dublin 2
PR2 9PP
Man Rev 2.2