

battery type: Lithium primary battery
battery size: ER17505H (A)
chemical system: Lithium Thionyl Chloride Battery

conditions, remarks

typical values for batteries stored for 1 year at max. 30°C

nominal voltage: 3.6 V

open circuit voltage: > 3.64 V new battery

capacity

nominal: 3600 mAh discharge at 1mA constant; 24hours/day; end voltage (EV):2.0V

min. operation time: ≥ 46 h at 62 Ω load; 24h/d; EV: 2.0V (for IQC measurement)

discharge

max. continuous current: 100 mA (achievable capacity approx. 50% when discharge to 2.0V, ta: 25°C)

max. pulse current: 200 mA 0.1s pulses every 2 minutes

load voltage (CCV): ≥ 3.25 V at 200 Ω load (for IQC measurement)

ambient temperature

range: - 55...85 °C operating temperature
 5...20 °C recommended storage temperature

Discharge Characteristics at 25°C

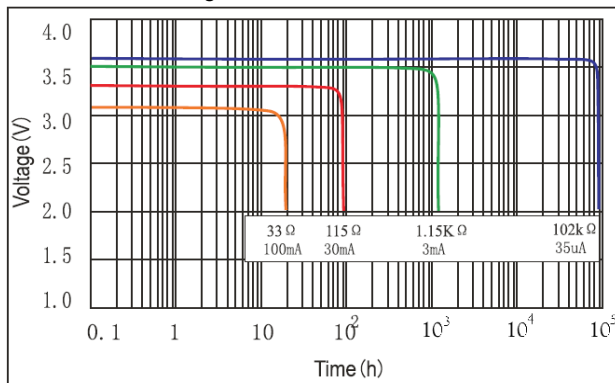

Voltage - Current

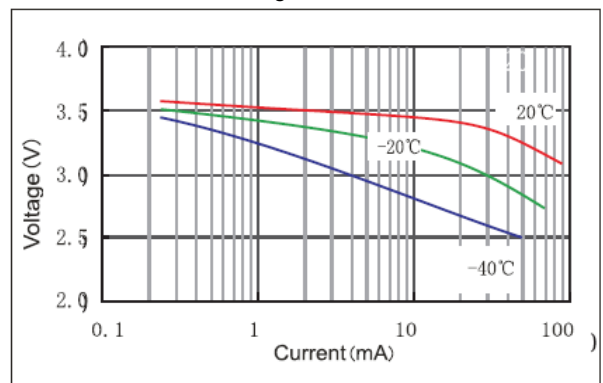

Capacity - Discharge Current (E.V. 2.0V)

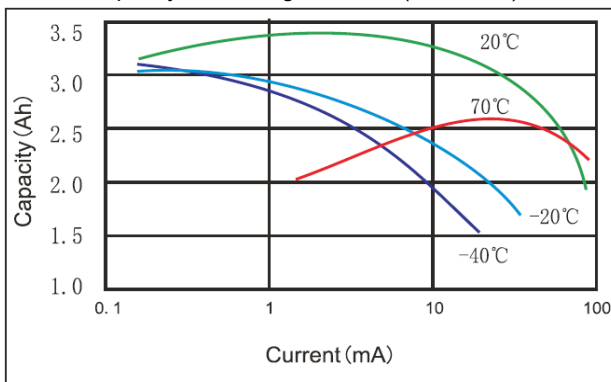

Discharge Characteristics after storage

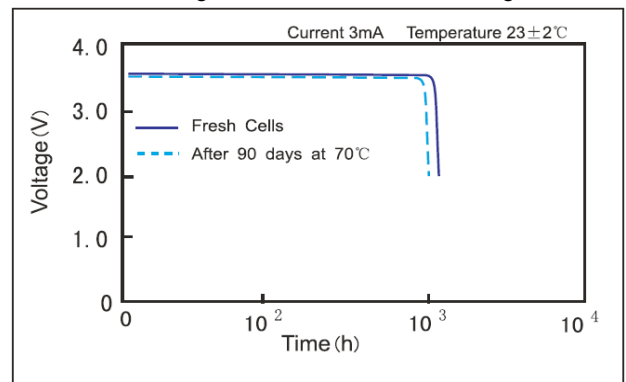

mechanical specifications

cell dimensions:

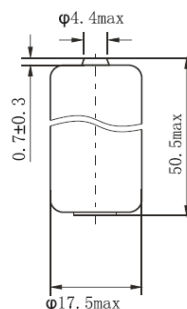

weight: 27 ± 1 g

dimensions in mm

112



ANSMANN Specifications for model:

data sheet no. / part no.

s.n.

author / date

Lithium Thionyl Chloride Battery ER17505H

1522-0038

704667

TG / 31.08.2023