



**7750QR**

**3/8" Pear Head Reversible  
Ratchets with 60 Teeth and 6°  
Action Angle**



## PRODUCT DETAILS



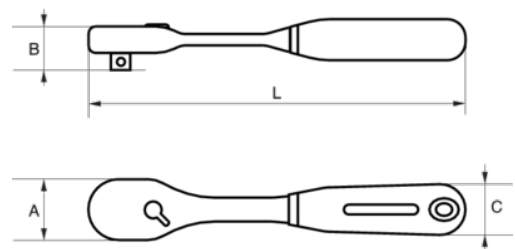

- 60 teeth/6° action angle
- Quick-release function for easy and safe operation
- Comfortable non-slip two-component handle with hanging hole for easy storage
- Quick, easy direction change lever on wrench head
- High quality CrV steel
- Nickel and matte chrome finish
- SB: Retail packed on an anti-theft plastic card
- Standards: ISO 3315/1174-2, DIN 3122/3120



**Follow the Fish!**

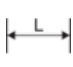

PRODUCT ATTRIBUTES

Product				A	B	C		
7750QR	3/8 in	6 °	60	32.5 mm	29.7 mm	24 mm	200 m	235 g
SB7750QR	3/8 in	6 °	60	32.5 mm	29.7 mm	24 mm	200 m	235 g

