

PRO-ELEC



9" Desk Fan Model: PEL01918 and PEL01919

Please read these instructions carefully before use and retain for future reference.

IMPORTANT SAFETY INFORMATION

- When using electrical appliances basic safety precautions should always be followed.
- Check that the voltage indicated on the rating plate corresponds with that of the local network before connecting the appliance to the mains power supply.
- This appliance is intended for domestic use only. It should not be used for commercial purposes.
- For indoor use only.
- This appliance can be used by children aged from 8 years and above and persons with reduced physical, sensory or mental capabilities or lack of experience and knowledge if they have been given supervision or instruction concerning the use of the appliance in a safe way and understands the hazards involved.
- Children shall not play with this appliance.
- Cleaning and maintenance shall not be made by children without supervision.
- There are no user-serviceable parts in this product. Refer servicing to qualified personnel.
- Do not operate this fan with a damaged plug or cord, after a malfunction or after being dropped or damaged in any way.
- If the supply cord is damaged, it must be replaced by the manufacturer, its service agent or similarly qualified persons in order to avoid a hazard.
- Ensure that the fan is switched off before removing the guard.
- Do not insert anything through the grille when the fan is in use.
- Make sure that the fan is on a stable surface when operating.
- It is recommended to unplug the fan from the mains socket when not in use.

ASSEMBLY

- Unscrew the rear guard retaining nut (1) from the motor shaft (2).
- Fit the rear guard (3) to the body of the fan with the handle uppermost.
- Lock into position by firmly tightening the rear guard retaining nut.

NOTE:- If fitted remove the shaft protective sleeve.

- Push the fan blades (4) onto the motor shaft aligning the pin in the slot.
- If not already attached, fit the decorative cap (5) to the front guard using the screws supplied.
- Hook the front fan guard (6) onto the rear fan guard and close the clips on the side of the front guard to fix it into position.
- Use the nut and bolt (7) provided, at the lower point lock the two guards together.

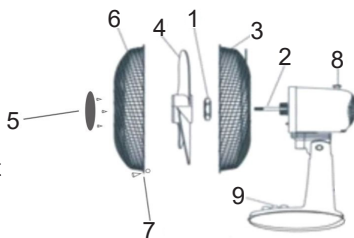

OPERATION

- Connect the mains plug to a suitable outlet.
- Oscillation: In order to make the fan oscillate, push down the oscillation knob (8). To stop the fan head from oscillating, pull up the oscillation knob.
- Select the desired speed using the speed control (9):
0 = device off
1 = Low speed
2 = High speed
- Caution: Press only one speed control button at a time. Permanent damage to the switch housing may result if two or more buttons are pressed simultaneously.

CLEANING & MAINTENANCE

- Before cleaning, switch the fan off and unplug from the power supply.
- To clean the fan, use a soft cloth to wipe off any dust. If the fan is very dirty, use a damp cloth and wipe dry.
- Do not use any chemicals, abrasives or solvents that could damage the fan.
- Store the fan in its original packaging in a dry, well ventilated area.
- The motor bearings are permanently sealed and do not require additional lubrication.

TECHNICAL SPECIFICATION

Power consumption	22W
Main voltage	220-240V~ 50Hz
Dimensions (HxWxD)	370 x 270 x 210mm
Weight	1.2kg



INFORMATION ON WASTE DISPOSAL FOR CONSUMERS OF ELECTRICAL & ELECTRONIC EQUIPMENT.

When this product has reached the end of its life it must be treated as Waste Electrical & Electronic Equipment (WEEE). Any WEEE marked products must not be mixed with general household waste, but kept separate for the treatment, recovery and recycling of the materials used. Contact your local authority for details of recycling schemes in your area.

Made in China
PO Box 13362 Dublin 2
PR2 9PP
Man Rev 2.3