



## LED WALL LIGHT Model: PELL0524

**Please read these instructions carefully before use and retain for future reference.**

### **IMPORTANT SAFETY INFORMATION**

- When using electrical appliances basic safety precautions should always be followed.
- Check that the voltage indicated on the rating plate corresponds with that of the local network before connecting the appliance to the mains power supply.

### **Safety Information for Installation and Operation**

- Avoid excessive force when installing.
- Always install on a surface that can support the weight of the fixture.



## INSTALLATION

- Turn off or isolate the mains supply.
- Pull off the outer decorative cover then remove the 4 screws and lift off the diffuser. Offer the rear part of the unit to the wall in the desired position with reference to the supply wiring and mark the location of the mounting holes.
- Drill the wall where marked taking care not to drill through hidden wiring or pipework and fit the wall plugs.
- Place the light unit against the wall and attach with the screws into the wall plugs.
- Feed the mains wiring through one of the grommets and connect to the terminal block:

Connect the positive supply wire (brown or red) to the terminal marked L.

Connect the neutral supply wire (blue or black) to the terminal marked N.

- Replace the diffuser and its screws then refit the decorative outer cover.
- Restore the mains supply.

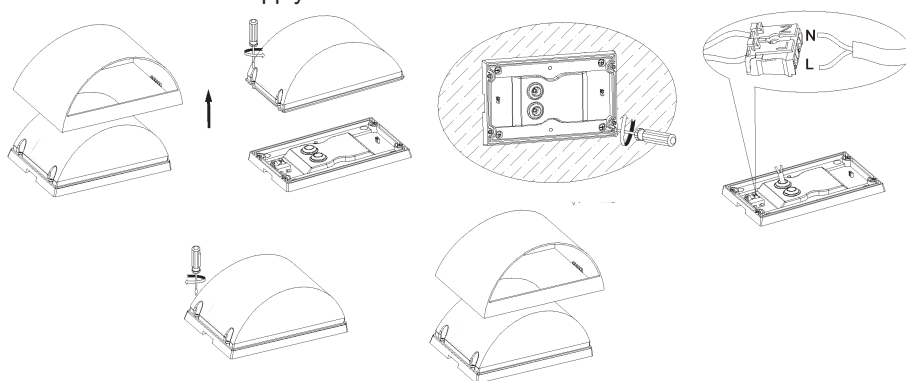

## CLEANING AND MAINTENANCE

- Clean only with a damp cloth with a little liquid detergent. Do not use any chemicals, abrasives or solvents that may damage the product.

## SPECIFICATIONS

Voltage	220-240V~50/60Hz 12W	<input type="checkbox"/>
IP rating	IP65	
Lamp type	84 LED 2835 non-replaceable	
Lumen	725 approx	
Operating conditions	-25°C ~ 45°C 10 ~ 90%RH	



### INFORMATION ON WASTE DISPOSAL FOR CONSUMERS OF ELECTRICAL & ELECTRONIC EQUIPMENT.

When this product has reached the end of its life it must be treated as Waste Electrical & Electronic Equipment (WEEE). Any WEEE marked products must not be mixed with general household waste, but kept separate for the treatment, recovery and recycling of the materials used. Contact your local authority for details of recycling schemes in your area.



Made in China  
Faraday Drive, Preston, PR2 9PP (UK)  
Riverside One, Sir John Rogerson Quay, Dublin 2 (EU)

Man Rev 1.0