

# UNIKEY

## Universal Manhole Key Kit

SKU: KEY004



### Instructions For Use

#### To fit an interchangeable tip:

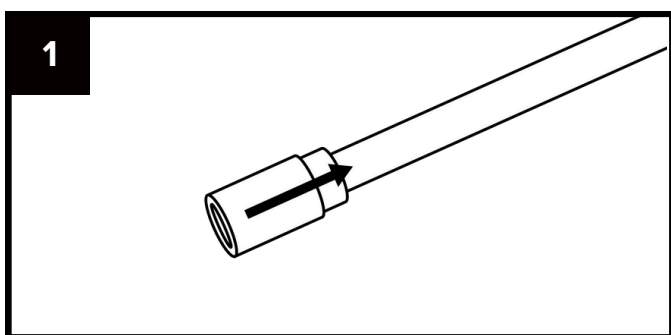

Pull the knurled collar back towards the handle.

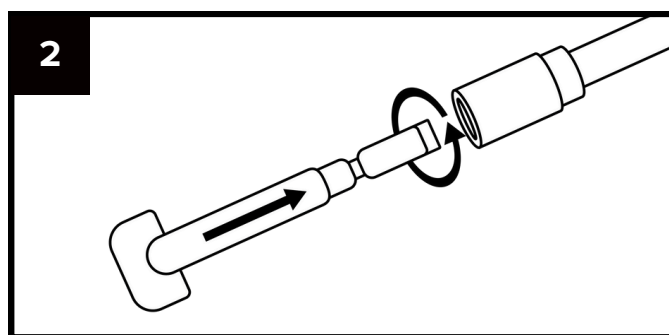

Insert tip and rotate to engage the male end into the handle recess.

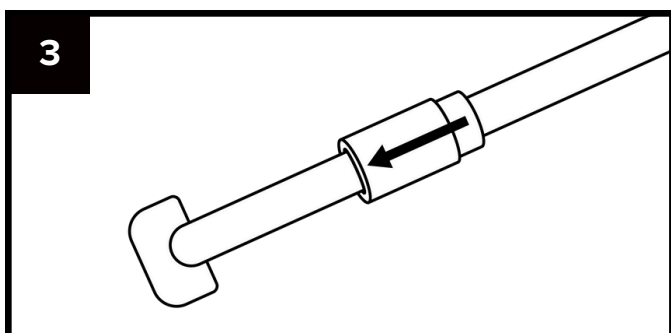

Release the collar once the tip is fully inserted.

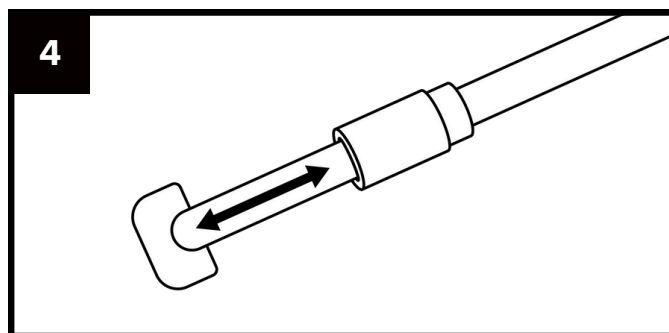

Check the tip is locked in place before use.

#### To remove a tip:

Pull back the collar towards the handle and pull the tip away from the handle at the same time.

#### Performance:

Unikey handles and tips have a 250kg Safe Working Load certified by Lloyds British Testing (1000kg straight pull destructive test.) Stopcock tip not tested.

All Unikey parts should be kept clean, with grease applied to the handle mechanism periodically. To prevent dirt ingress a key may be left mounted to the handle.