

groov▶▶e

GV-BT750 ULTRA

*Bluetooth Headphones
with Wireless Charging*



USER MANUAL

wireless | CHARGING
AUDIO | **wired** **ULTRA**  **Bluetooth®**



30 Day Right To Return

We do not envisage any problems occurring with your Groov-e GV-BT750 Ultra Wireless Headphones. However, for your peace of mind, should any fault occur, please return it within 30 days to your retailer with proof of purchase for an exchange or refund.



12 Month Guarantee

This product is guaranteed for twelve months. Please retain your receipt as this will be required as proof of purchase in the vent that the device does not perform as expected then please contact your original point of purchase, should you require further assistance then please contact us.



Extended Warranty

Please register your product within 30 days from date of purchase www.groov-e.co.uk/warranty. Proof of purchase required.



Contact Us

Reach out to us at info@groov-e.co.uk or visit www.groov-e.co.uk

"Congratulations on your purchase and **Thank You** for choosing the **Groov-e GV-BT750 ULTRA Bluetooth Headphones**
Please read the guide carefully before using".

CAUTION

- 1.** When not in use for a long period of time please turn off the headphones and store carefully to avoid any damage.
- 2.** In order to prolong the battery life, please charge every 6 months.
- 3.** Please charge the headphones first if it has been left unused for a long time.
- 4.** The battery in the headphones is original and please do not attempt to change it yourself.
- 5.** Please keep the headphones in a dry place.
- 6.** Please keep away from temperatures in excess of 60 C to avoid battery blast accident.
- 7.** Please don't bend or twist the headphones bracket to avoid deformation.
- 8.** Please do not remove the ear-cushions.
- 9.** Do not play at high volumes for long periods at a time. to avoid potential hearing damage.
- 10.** Do not use the headphones in a dangerous place or whilst driving.

OVERVIEW

Box Contents:

Bluetooth Headphones *1pc

Micro USB Cable *1pc

3.5mm audio cable *1pc

User Manual *1pc

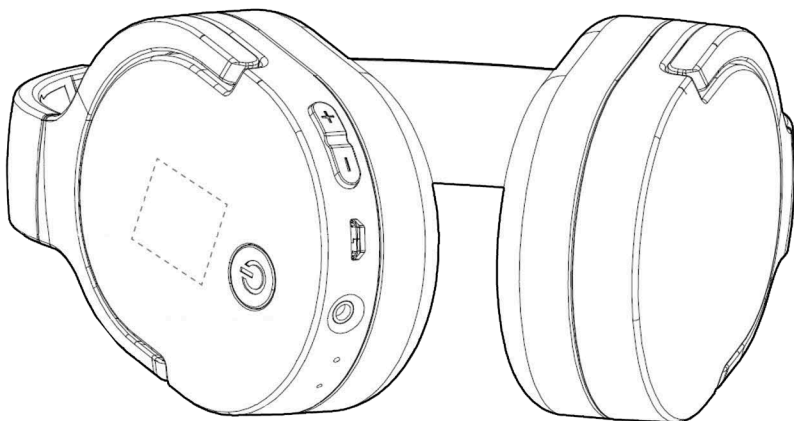
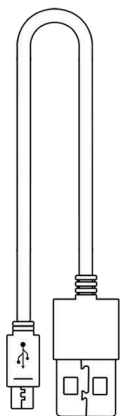
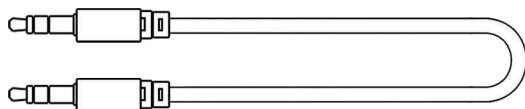

OVERVIEW

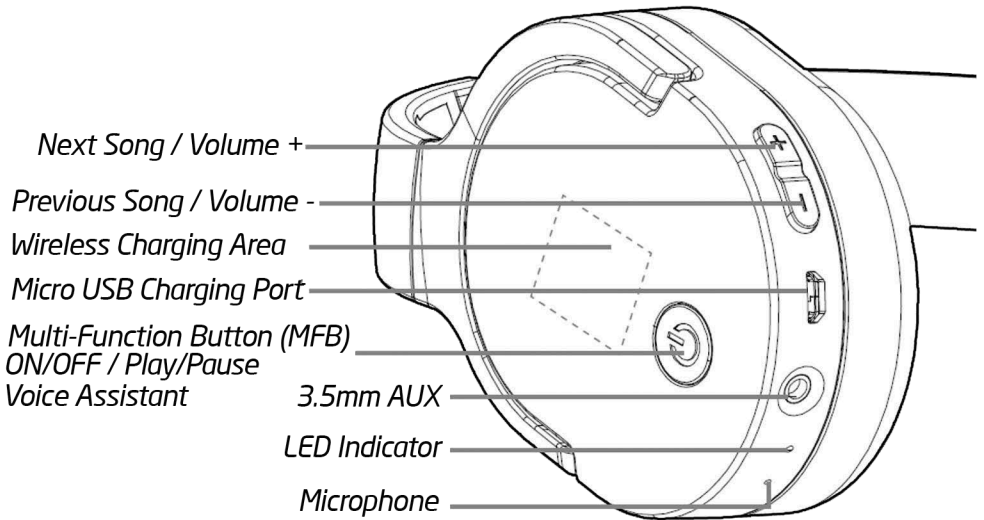

OPERATION

Before using the headphones, you must charge the battery and pair the headphones with a compatible device.

Note: The headphones can be charged via a wired USB connection or wirelessly using a wireless charging dock.

WIRED CHARGING

The packaging contains a Micro USB cable that can be connected to your computer or other USB charging device. Plug the Micro USB end of the included USB cable into the USB micro port charger connector under the left ear-cap of the headphone. Plug the other end into a USB port on your computer or other devices made for USB charging. The indicator light will be red while charging. Once fully charged, the indicator light will be blue. Charging Time approximately 2-3 Hours.

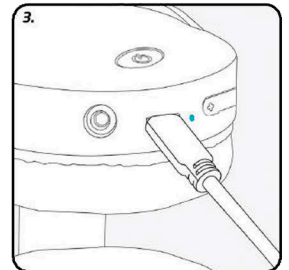
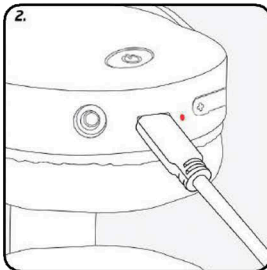
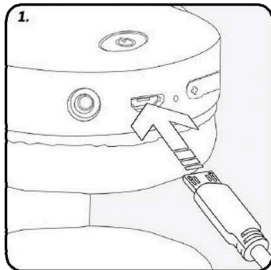

Note: The headphones have a built-in lithium battery. Please fully charge for at least 4 hours before initial use.

WIRELESS CHARGING

Place the wireless charging area of the headphones on to a wireless charging pad the LED charging indicator light is red while charging. Once fully charged, the indicator light will be blue. Charge time is approximately 2-3 hours on an empty battery based on charging at 5.0V = 2A

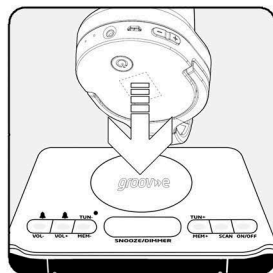

PAIRING

Ensure that your Phone or Bluetooth enabled device is switched on.

To pair switch on the headphones by pressing and holding the MFB for 3-4 seconds and a confirmation tone is heard.

The headphones enter the pairing mode, and the blue and red indicator light starts to flash alternately.

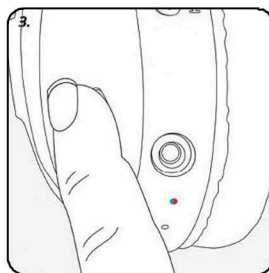
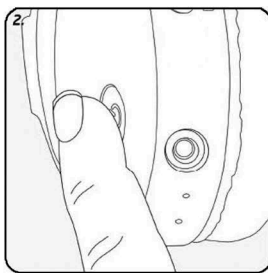

Note: To pair the Headphones to a new device ensure that if they have been previously paired to another device that the original device is switched off.

Activate the Bluetooth feature on your phone or Bluetooth device, and set it to search for Bluetooth devices.

Select "GV-BT750" from the list of found devices on your phone or Bluetooth device, You will hear a confirmation tone once the headphones have connected successfully.

When connected, the LED indicator changes to a blue flashing light.

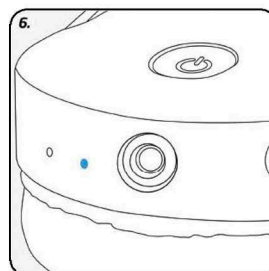
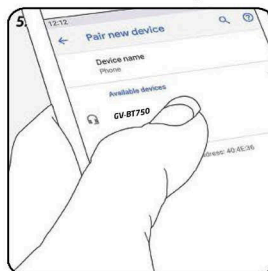
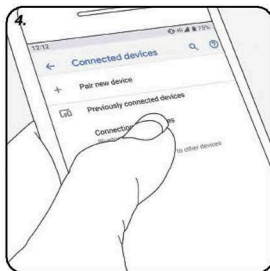

Note: If the headphones have been previously paired with another device they will automatically connect with that device if the device is powered on and within connecting range, the headphones will enter standby mode with a blue flashing light.

ADJUST THE VOLUME

Turn the volume up or down by pressing and holding the volume +/- button during a call or while listening to music

A warning tone is heard, When the volume reaches maximum and minimum levels.

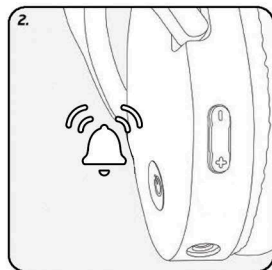
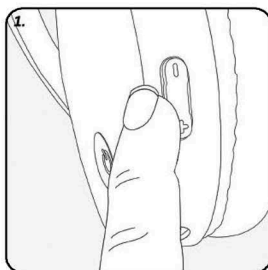

CALLS

To make a call, use your mobile phone in the normal way when the headset is connected to it. When a phone call comes in, quickly press the MFB to answer it, or press and hold about 1.5 seconds to reject the call. During a call, short press MFB to end it.

VOICE ASSISTANT

To use Siri / Google function, quickly press MFB twice to activate the Siri / Google on your phone. This function is based on your phone supporting Siri / Google.

LISTEN TO MUSIC

To listen to music, connect the headphones to your phone or compatible Bluetooth devices that support A2DP Bluetooth profile. The available music functions depend on your Bluetooth devices. If you receive or make a call while listening to music, the music is paused until the call ends.

To play a song select on your music player and press the MFB on the headphones.

To resume or pause playing a song quickly press the MFB.

To select the next song during playback, press the volume up button.

To select the previous song, press the volume down button.

DISCONNECT/SWITCH OFF THE HEADPHONES

To disconnect the headphones from your device switch off the headphones by pressing and holding the MFB for 5-6 seconds you will hear a confirmation tone.

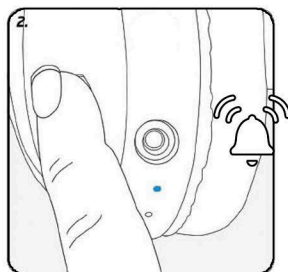
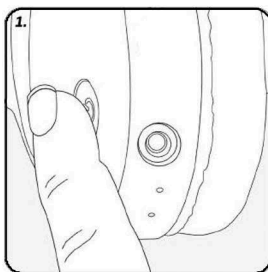

RECONNECT/SWITCH ON THE HEADPHONES

To connect the headphones to the phone or device that you last used them with switch on the headphones by holding the MFB for 3-4 seconds and/or make the connection in the Bluetooth menu of your device, a confirmation tone is heard once successful.

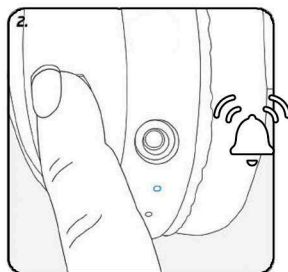
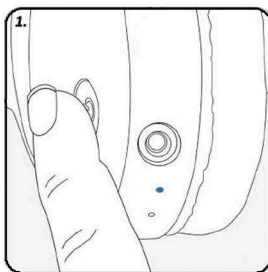

PASSIVE MODE

You can use "GV-BT750" as wired headphones to save battery power. Simply connect one end of the 3.5mm -3.5mm audio cable to the bottom of the left ear cup and the other end to the 3.5mm output socket of your phone or Bluetooth device. Inserting the audio cable will disable the wireless functionality.

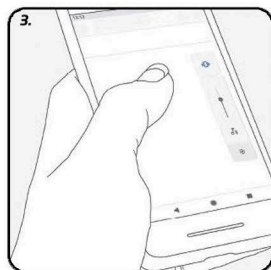
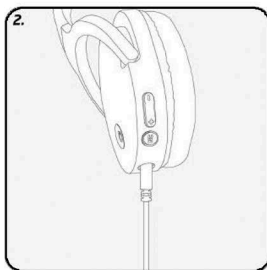
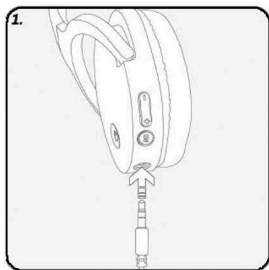

LOW BATTERY WARNING

There will be a warning tone every 40 seconds.

POWER-OFF AT LOW BATTERY

When battery drops below a certain level the headphones will switch off automatically.

SPECIFICATIONS:

Bluetooth Version: 5.0

Bluetooth Profiles: HSP, HFP, A2DP and AVRCP

Wireless range: 10M (open area)

Battery: Lithium battery 250mAH

Music playing time up to 30 hours

Charging time: 2-3 hours

Standby time: 300 hours

Driver unit: 40mm neodymium

Impedance: 32 ohms +/-15%

Frequency: 20 Hz- 20K Hz

Sensitivity: 106dB+/-3dB

Microphone Sensitivity: -58dB

LED indicator

FEATURES:

- 40mm drivers for superior sound
- Bluetooth or Coded - both options for you to enjoy!
 - 30 hours wireless audio playback (Bluetooth)
 - 3.5mm headphone jack for coded audio playback (non-Bluetooth)
- Wireless charging technology charges your headphones without wires! (wireless charging pad required)
- Voice assistant enabled
- Super bass
- Soft, on-ear cushions for long listening comfort
- Folding design for easy storage
- Swivel earcups
- Rechargeable battery
- Built-in Mic for hands-free calls
- Micro-USB charging cable (included)
- Removable 3.5mm audio cable (included)



Bluetooth Connectivity



Wireless Charging



Wireless Audio Playback



Super Bass



Voice Assistant



Soft Ear Pads



Hands-Free Microphone



Folding Design



Removable Audio Cable

Battery Removal/Disposal

This product contains batteries and should not be treated as normal household waste and should be recycled. Please take it to your nearest collection facility or for further details contact your local council or visit www.recycle-more.co.uk.

Batteries contain substances that may be harmful to the environment and human health. Keep out of the reach of children and seek immediate medical help if swallowed.

Never throw batteries into a fire or attempt to open the outer casing.

Should your product develop a fault and your battery needs replacing for further advice on how to safely remove your battery please visit our website at www.groov-e.co.uk

Environment Protection

Waste electrical products should not be disposed of with household waste. Please recycle where facilities exist. Check with you Local Authority or retailer for recycling advice.



GUARANTEE

Subject to the conditions stated below, Groov-e guarantees this equipment against defects in workmanship or materials of its mechanical and electronic component parts (excluding styling, battery cells, magnetic tapes, re-chargeable batteries, user removeable memory devices) for a period of one year from the date of purchase. This product will be repaired or if necessary replaced free of charge if it has been proven to be defective within the one year warranty period.

Conditions

- 1)** Claims under this guarantee should be made through the authorised dealer/retailer from whom the equipment was purchased. If this is not possible, please contact Groov-e directly.
- 2)** This guarantee is only valid when the equipment is purchased within the United Kingdom and a valid proof of purchase has been provided.
- 3)** This guarantee excludes:
 - (i)** All damage caused through accident, misuse, wear and tear, neglect, installation and/or use in a manner inconsistent with technical and safety standards in a country other than the country of purchase
 - (ii)** Alterations or adjustments made to equipment
 - (iii)** Loss of data resultant from malfunction of hard drive or other storage device
 - (iv)** Damage caused to any third party device as a result of using the product
- 4)** No liability under this guarantee shall be incurred:
 - (i)** In respect of damage or loss occurring during transit to or from the purchaser
 - (ii)** Where the serial number plate of the equipment has been removed or altered in any way.
- 5)** Groov-e shall not be liable for consequential damage, loss or injury arising from or in connection with the equipment, excepting only that nothing in this condition shall or shall be construed so as to exclude or restrict liability for negligence.
- 6)** The cost of carriage to and from Groov-e shall be borne by the purchaser.
- 7)** This guarantee is personal to the original purchaser and is not transferable
- 8)** If the equipment, in respect of which a claim hereunder is made, is found on examination to comply with the published specifications, a test fee may be incurred.

This guarantee is in addition to and does not in any way affect any statutory or other right of consumer purchasers, including those rights in relation to sections 13 to 15 of the Sale of Goods Act 1979, the Sale and Supply of Goods to Consumer Regulations 2002, The Consumer Rights Act 2015 or the Sale of Goods and Supply of Services Act 1980 (for ROI).

DECLARATION OF CONFORMANCE

Groov-e hereby declares that this product is in compliance with the essential requirements and other relevant provisions of the Radio Equipment Directive 2014/53/EU. The complete declaration of conformity can be requested from us at

groov»e

Unit J

Braintree Industrial Estate

Braintree Road

Ruislip

Middlesex

HA4 0EJ UK

www.groov-e.co.uk

Email: info@groov-e.co.uk

Telephone: 020 8839 0978

Authorised EU Representative

Rashmian EU Ltd

Robwyn House

Suite 3E

Corrintra

Castleblayney

Co. Monaghan

Ireland

Register your purchase for extended warranty

www.groov-e.co.uk/warranty