

PRO-ELEC



**DESK LAMP DIMMABLE
CCT CHANGING 12W
Model PELL0503**

Please read these instructions carefully before use and retain for future reference.

IMPORTANT SAFETY INFORMATION

- Check that the voltage on the rating label matches the mains voltage supply before connecting the PSU to the mains.
- This product is for indoor use only.
- The lamp contains non-replaceable LED's and so at the end of their life the lamp should be replaced.
- Do not look directly into the LED's as it may damage your eyesight.
- Always disconnect from the mains supply when not in use.
- Place on a flat level surface before use.

ASSEMBLY

1. Remove the screw from the bottom of the lamp stem.
2. Insert the stem into the base noting the control dial goes towards the larger portion of the base.
3. Invert the assembly and fit and tighten the screw removed previously to lock the stem into place.

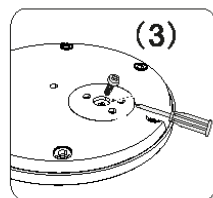
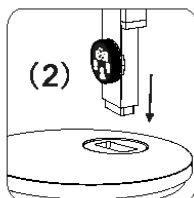
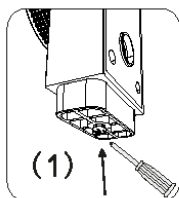

OPERATION

- Connect the PSU DC output to the socket on the lamp and connect the PSU to the mains and turn on the power.
- Touch the ON/OFF switch momentarily to turn the lamp on or off.

NOTE: When powering on again the initial LED state is set at whatever colour temperature and brightness when last powered off.

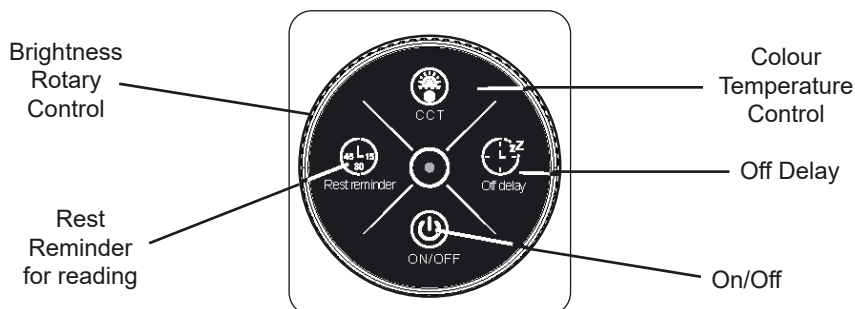

- Short press the CCT button to switch between colour modes.

Three modes are available:-

1. Warm light (3000K)
 2. Day light (3800K)
 3. Cool light (5700K)
- Rotate the main rotary control to adjust the stepless brightness setting.

Off Delay

- Touch the switch, lamp will turn off automatically in 90 seconds.

Rest reminder for reading

- Short touch to set the rest reminder to 30 minutes.
- Long press to test rest reminder function - lamp will flash in 5 seconds.

SPECIFICATIONS

- This product contains a light source of energy efficiency class F.

| | |
|--------------------|---|
| Power | 12W |
| Colour Temperature | 3000K / 3800K / 5700K (warm light/day light/cool light) |
| Lumens | 560lm (Max) |
| PSU Input Voltage | 220-240V~50/60Hz |
| PSU Output Voltage | DC 12V 800mA |
| Classification | Class II for complete lamp |

- The position of the lamp can be adjusted by moving both the main vertical stem through 65 degrees and the LED strip by 180 degrees in total.
- The lamp may also be rotated on it's base by 40 degrees.

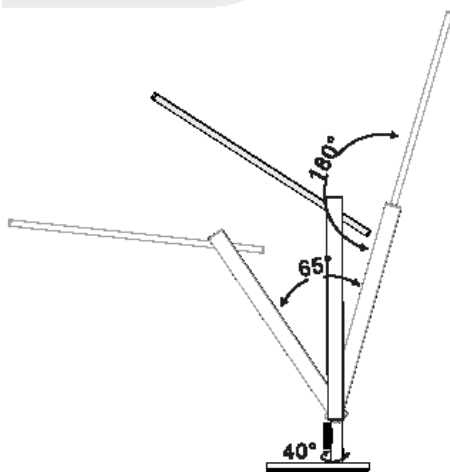

CLEANING AND MAINTENANCE

- Clean the product with a soft, dry cloth only.
- Do not use any solvents or abrasive chemical cleaners.

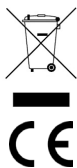

INFORMATION ON WASTE DISPOSAL FOR CONSUMERS OF ELECTRICAL & ELECTRONIC EQUIPMENT.

When this product has reached the end of its life it must be treated as Waste Electrical & Electronic Equipment (WEEE). Any WEEE marked products must not be mixed with general household waste, but kept separate for the treatment, recovery and recycling of the materials used. Contact your local authority for details of recycling schemes in your area.

Made in China
Faraday Drive, Preston, PR2 9PP (UK)
Riverside One, Sir John Rogerson Quay, Dublin 2, D02 X576 (EU)
Man Rev 2.0