

## Installation Instructions and Care

### Safety Markings



### Cleaning

Clean this light fitting only with a soft dry cloth

Do not use any chemical or abrasive cleaners.

### Lamp Replacement

The light source in your striplight is a bespoke array of LEDs. These LEDs have a life expectancy of many tens of thousands of hours and so are unlikely to need replacing within the lifetime of the fitting.

If one or more of the LEDs do not light, you will need to replace your light fitting, there are no user serviceable parts inside.

### Eventually, you may want to replace this light fitting

When your light fitting comes to the end of its life or you choose to update or upgrade it by replacing it, please do not dispose of it with your normal household waste, please recycle where facilities exist. When you need to dispose of this fitting, check with your retailer or local authority for suitable options. New regulations require the recycling of Waste from Electrical and Electronic Equipment (European "WEEE Directive" effective August 2005—UK WEEE Regulations effective 2nd January 2007). Environment Agency Registered Producer: WEE/GA0248QZ



If you experience problems...

If your light is defective or develops a fault, please return it to the place where you bought it. You can call our Helpline for advice. The Helpline will gladly give advice on any aspect of any Eterna Lighting product but may not be able to give specific instructions regarding individual installations.

**If in doubt, consult a qualified electrician.**

Help Line

Tel: 01933 673 144

Fax: 01933 678 083

Email: [sales@eterna-lighting.co.uk](mailto:sales@eterna-lighting.co.uk)

For all other information visit our website [www.eterna-lighting.co.uk](http://www.eterna-lighting.co.uk)

Issue 091005-2-PA



## SAFETY AND INSTALLATION INSTRUCTIONS

### Model(s): **LEDS9WH, LEDS15WH, LEDS27WH**

#### Link and Light LED Striplight

**IMPORTANT!** Please read these instructions before installing your new fitting.  
Please retain for future reference.

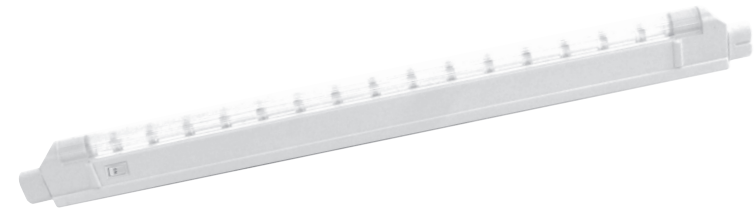

#### Pack Contents

LED strip light	x 1
Link & Light ® 2m mains lead	x 1
"F" clip	x 2
"U" clip	x 2
25mm screws	x 2
14mm screws	x 2
Plastic wall plug	x 2

# General Information and Safety Instructions

## Read this first

Check the pack and make sure you have all of the parts listed on the front of this booklet. If not, contact the outlet where you bought this product.

This product contains glass, care must be taken when assembling, fitting or handling to prevent personal injury or damage to the product.

**This light fitting must be installed by a competent person in accordance with the Building Regulations** making reference to the current edition of the IEE Wiring Regulations (BS7671). The Building Regulations may be obtained from OPSI or viewed and downloaded from [www.communities.gov.uk](http://www.communities.gov.uk) following the link for Building Regulations.

As the buyer, installer and/or user of this product it is your own responsibility to ensure that this fitting is fit for the purpose for which you have intended it. Eterna Lighting cannot accept any liability for loss, damage or premature failure resulting from inappropriate use.

### If in any doubt, consult a qualified electrician.

This product is designed and constructed according to the principles of the appropriate British Standard and is intended for normal domestic service. Use of this fitting in any other environment, for example where prolonged periods of use may be expected and/or higher than normal ambient temperatures, may result in a foreshortened working life.

The lamps (tubes) supplied with this fitting are consumable parts and therefore may be outside of any warranty offered.

This fitting is not suitable for frequent use for extended periods in environments with higher than normal ambient temperatures for example: lighting public or shared spaces or in care facilities.

Switch off the mains before commencing installation and remove the appropriate circuit fuse.

Disconnect from the electrical supply before flash or high voltage testing.

Suitable for indoor use only.

This product is suitable for use in living areas, and Bathroom dry (Outside) Zones only (see current IEE Wiring Regulations for details). It is **not** suitable for Bathroom Zones 0, 1, 2, or other areas where contact with moisture is likely. **If being fitted in a bathroom a 30mA RCD must be used.**

This product is suitable for installation on surfaces with normal flammability (indicated by the "F" in a triangle) e.g. wood, plasterboard, masonry. It is not suitable for use on highly flammable surfaces (e.g. polystyrene, textiles).

Before making fixing hole(s), check that there are no obstructions hidden beneath the mounting surface such as pipes or cables.

The chosen location of your new fitting should allow for the product to be securely mounted and safely connected to the mains supply (lighting circuit).

If the location of your new fitting requires the provision of a new electrical supply, the supply must conform with the requirements of the Building Regulations making reference to the current edition of the IEE Wiring Regulations (BS7671).

This product is designed for permanent connection to fixed wiring: this should be either a suitable lighting circuit (protected with a 5 or 6 Amp MCB or fuse) or a fused spur (with a 3 Amp fuse) via a fused connection unit. We recommend that the supply incorporates a switch for ease of operation.

The cores in the mains lead are coloured in accordance with the following code:

Live – Brown or Red

Neutral – Blue or Black

When making connections, ensure that the terminals are tightened securely and that no strands of wire protrude. Check that the terminals are tightened onto the bared conductors and not onto any insulation. Wrap loose terminal blocks well with insulating tape.

This fitting is double insulated; do not connect any part to earth.

You are advised at every stage of your installation to double-check any electrical connections you have made. After you have completed your installation there are electrical tests that should be carried out: these tests are specified in the Wiring Regulations (BS7671) referred to in the Building Regulations. If in doubt, consult a qualified electrician.

# Installation Instructions and Care

## Installation

1. Select the type of brackets you need to use and mark off the fixing points. If fixing to a shelf or under a cupboard, check the screw size required and screw into place. See figures 1 and 2, opposite.
2. If fixing directly to the wall, drill holes using a N°8/ 5mm drill bit to a depth of 30mm and insert wall plugs.
3. Secure the selected brackets in place using the screws supplied.
4. Attach the fitting to the clips.
5. Connect the mains lead or link lead (not supplied) to the socket on your fitting.
6. Restore the power supply and switch on.
7. Note that when installed and connected in a chain with other Link&Light fittings, the switch in your fitting will turn the fitting on and off but have no effect on any other fittings in the chain or the power routed through.

### How to link multiple fittings together.

#### Option 1.

The light fittings can be butted together to form a line of up to a maximum of 6 fittings. Simply remove the connector caps and push the fittings together. Use the mains lead cable to connect the first fitting and the mains via a spur or junction box (not supplied).

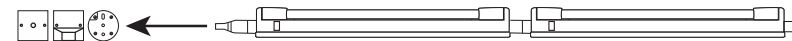

#### Option 2.

Connect link leads (available separately) between each fitting and once all lights have been connected, connect the mains lead to the mains via a spur or junction Box (not supplied).

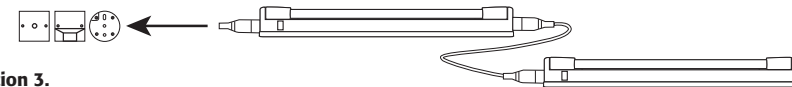

#### Option 3.

For more than one unlinked light, use a socket block (available as an optional extra) and simply plug the plug into your nearest socket outlet.



Fig. 1

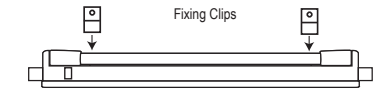
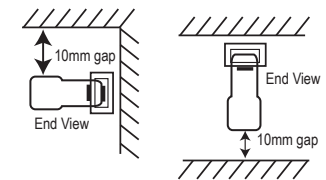

Fig. 2



## Warning

The leads supplied with your light fitting and the sockets incorporated in your fitting are designed to give protection against any possible electrical hazard. The mains lead is terminated in a socket marked NLS and this lead should be used to supply mains to your fitting or chain of fittings. Under no circumstances should you attempt to adapt the link lead to supply power to the opposite end of your fitting as this will leave live pins exposed at the mains input end of the fitting. Altering or adapting any of the leads, other than shortening the mains supply lead, will invalidate your guarantee and could present a severe electrical shock hazard.