

1.4 EPIC® H - B E

Einsätze / Inserts / Inserts

Technische Daten:

- Kontaktzahlen: 6, 10, 16, 24, 32, 48 (+ PE)

Schraubanschluss / Crimpanschluss:

- Bemessungsspannung: VDE: 500 V EPIC® H-BE 6-48
UL: 600 V EPIC® H-BE 6-48
CSA: 600 V EPIC® H-BE 6-48
- Bemessungsstrom: VDE: 16 A EPIC® H-BE 6-48
UL: 16 A EPIC® H-BE 6-48
CSA: 16 A EPIC® H-BE 6-48

Käfigzugfederanschluss:

- Bemessungsspannung: VDE: 500 V EPIC® H-BE 6-48
UL: 600 V EPIC® H-BE 6-48
CSA: 600 V EPIC® H-BE 6-48
- Bemessungsstrom: VDE: 16 A EPIC® H-BE 6-48
UL: 16 A EPIC® H-BE 6-48
CSA: 16 A EPIC® H-BE 6-48
- Verschmutzungsgrad: 3
- Bemessungsstoßspannung: 6kV

Anschluss technik:

- Schraubanschluss: 0,5-2,5 mm²
- Crimpanschluss: 0,5-4 mm²
- Käfigzugfederanschluss: 0,5-2,5 mm²
- Temperaturbereich: -40 °C bis +100 °C,
kurzzeitig bis +125 °C

Kontakte:

- Schraubanschluss: Kupferlegierung - hartversilbert
- Crimpanschluss: Kupferlegierung –
hartversilbert/hartvergoldet
- Käfigzugfederanschluss: Kupferlegierung - hartversilbert
- Steckzyklen: 100 (je nach Anwendungsfall
höhere Steckzyklen möglich)

Durchgangswiderstand:

- Schraubanschluss: <2 mOhm
- Crimpanschluss: <2 mOhm
- Käfigzugfederanschluss: 1,5-4 m Ohm

Technical Data:

- Number of contacts: 6, 10, 16, 24, 32, 48 (+ PE)

Screw Termination/Crimp termination

- Rated voltage: VDE: 500 V EPIC® H-BE 6-48
UL: 600 V EPIC® H-BE 6-48
CSA: 600 V EPIC® H-BE 6-48
- Rated current: VDE: 16 A EPIC® H-BE 6-48
UL: 16 A EPIC® H-BE 6-48
CSA: 16 A EPIC® H-BE 6-48

Cage clamp:

- Rated voltage: VDE: 500 V EPIC® H-BE 6-48
UL: 600 V EPIC® H-BE 6-48
CSA: 600 V EPIC® H-BE 6-48
- Rated current: VDE: 16 A EPIC® H-BE 6-48
UL: 16 A EPIC® H-BE 6-48
CSA: 16 A EPIC® H-BE 6-48
- Pollution degree: 3
- Dimensioning transient: 6 kV

Termination technique:

- Screw termination: 0,5-2,5 mm²
- Crimp termination: 0,5-4,0 mm²
- Cage clamp termination: 0,5-2,5 mm²
- Temperature range: -40 °C – +100 °C
for a short term up to +125 °C

Contacts:

- Screw termination: Copper alloy, silver plated
- Crimp termination: Copper alloy, silver plated/
gold plated
- Cage Clamp termination: Copper alloy, silver plated
- Mating cycles: 100 (higher mating cycles
depends on the application)

Contact resistance:

- Screw termination: <2 mOhm
- Crimp termination: <2 mOhm
- Cage Clamp termination: 1,5 - 4 mOhm

Caractéristiques techniques:

Raccord à visser/Raccord à souder

- Nombre de contacts: 6, 10, 16, 24, 32, 48 (+ PE)
- Tension nominale: VDE: 500 V EPIC® H-BE 6-48
UL: 600 V EPIC® H-BE 6-48
CSA: 600 V EPIC® H-BE 6-48
- Courant nominale: VDE: 16 A EPIC® H-BE 6-48
UL: 16 A EPIC® H-BE 6-48
CSA: 16 A EPIC® H-BE 6-48

Raccord lame de pression

- Tension nominale: VDE: 500 V EPIC® H-BE 6-48
UL: 600 V EPIC® H-BE 6-48
CSA: 600 V EPIC® H-BE 6-48
- Courant nominale: VDE: 16 A EPIC® H-BE 6-48
UL: 16 A EPIC® H-BE 6-48
CSA: 16 A EPIC® H-BE 6-48
- Degré de pollution: 3
- Dimensionnement de choc: . . 6 kV

Raccordement:

- Raccord à visser: 0,5-2,5 mm²
- Raccord à sertir: 0,5-4 mm²
- Raccord lame de pression: . . . 0,5-2,5 mm²
- Gamme de température: . . . -40 °C – +100 °C,
à court terme jusqu'à +125 °C

Contacts:

- Raccord à vis: Alliage cuivre, argenté
- Raccord à sertir: Alliage cuivre, argenté/doré
- Raccord lame de pression: . . . Alliage cuivre, argenté
- Cycles d'insertion: 100 (selon le cas cycles
d'insertion plus important)

Résistance de passage:

- Raccord à visser: < 2 mOhm
- Raccord à sertir: < 2 mOhm
- Raccord lame de pression: . . . 1,5 – 4 mOhm

1.4 EPIC® H - B E

Einsätze / Inserts / Inserts

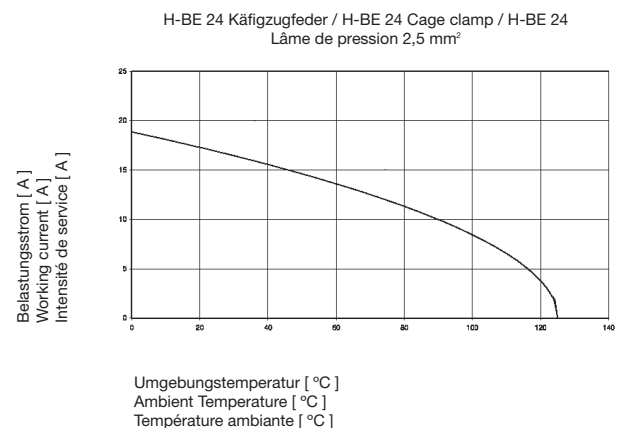
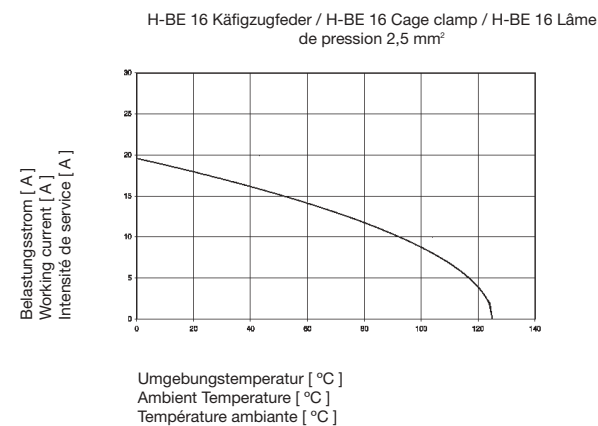
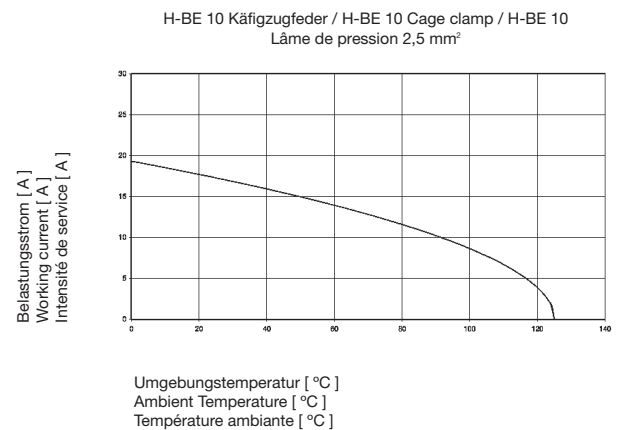
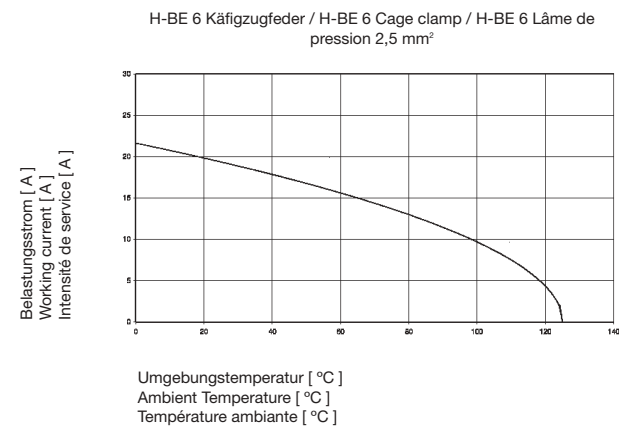
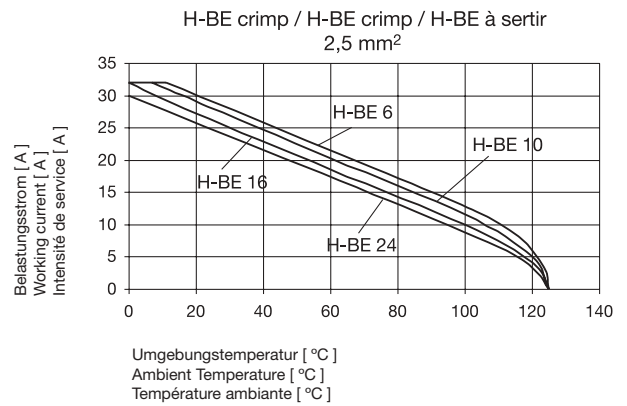
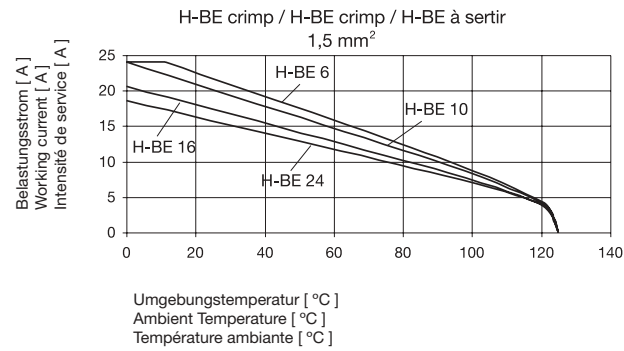
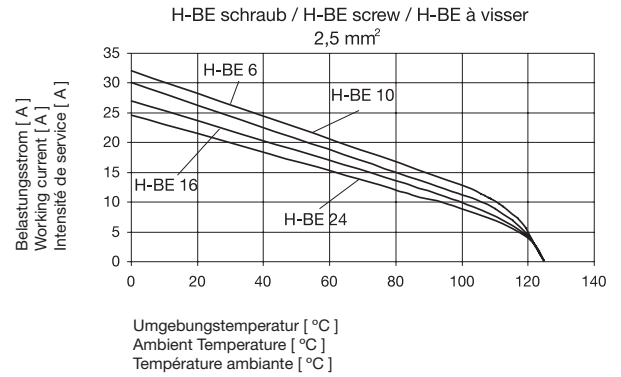
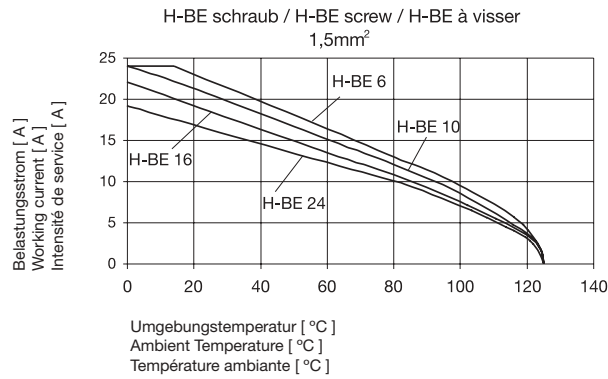

1.4 EPIC® H - B E

Einsätze / Inserts / Inserts

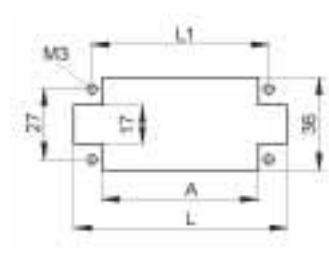
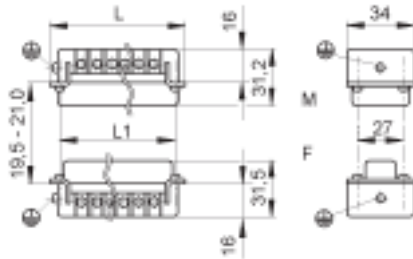

Montageausschnitt
Panel cut-out
Découpe de montage

Schraubanschluss / Screw termination / Raccord à visser

H-BE 6

| Artikel part article | Version version version | Art.Nr. part No. N° art. | Drahtschutz wire protection protection de fil | Kontakte contacts contacts | L | L1 | A |
|----------------------------|-------------------------------|--------------------------------|---|----------------------------------|----|----|----|
| H-BE 6 SS | Stift / male / mâle | 10190000 | ● | 6 | 51 | 44 | 39 |
| H-BE 6 BS | Buchse / female / femelle | 10191000 | ● | 6 | 51 | 44 | 39 |
| H-BE 6 SS | Stift / male / mâle | 10190100 | | 6 | 51 | 44 | 39 |
| H-BE 6 BS | Buchse / female / femelle | 10191100 | | 6 | 51 | 44 | 39 |

Gehäuse / Housings / Boîtiers:
3.2: H-B 6

Ansicht anschlussseitig
View from cable side
Vue côté raccordement

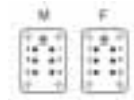

H-BE 10

| Artikel part article | Version version version | Art.Nr. part No. N° art. | Drahtschutz wire protection protection de fil | Kontakte contacts contacts | L | L1 | A |
|----------------------------|-------------------------------|--------------------------------|---|----------------------------------|----|----|----|
| H-BE 10 SS | Stift / male / mâle | 10192000 | ● | 10 | 64 | 57 | 52 |
| H-BE 10 BS | Buchse / female / femelle | 10193000 | ● | 10 | 64 | 57 | 52 |
| H-BE 10 SS | Stift / male / mâle | 10192100 | | 10 | 64 | 57 | 52 |
| H-BE 10 BS | Buchse / female / femelle | 10193100 | | 10 | 64 | 57 | 52 |

Gehäuse / Housings / Boîtiers:
3.2: H-B 10

Ansicht anschlussseitig
View from cable side
Vue côté raccordement

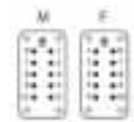

H-BE 16

| Artikel part article | Version version version | Art.Nr. part No. N° art. | Drahtschutz wire protection protection de fil | Kontakte contacts contacts | L | L1 | A |
|----------------------------|-------------------------------|--------------------------------|---|----------------------------------|------|------|----|
| H-BE 16 SS | Stift / male / mâle | 10194000 | ● | 16 | 84,5 | 77,5 | 71 |
| H-BE 16 BS | Buchse / female / femelle | 10195000 | ● | 16 | 84,5 | 77,5 | 71 |
| H-BE 16 SS | Stift / male / mâle | 10194100 | | 16 | 84,5 | 77,5 | 71 |
| H-BE 16 BS | Buchse / female / femelle | 10195100 | | 16 | 84,5 | 77,5 | 71 |

Gehäuse / Housings / Boîtiers:
3.2: H-B 16

Ansicht anschlussseitig
View from cable side
Vue côté raccordement

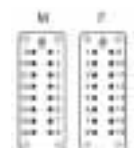

1.4 EPIC® H - B E

Einsätze / Inserts / Inserts

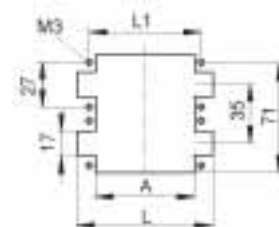
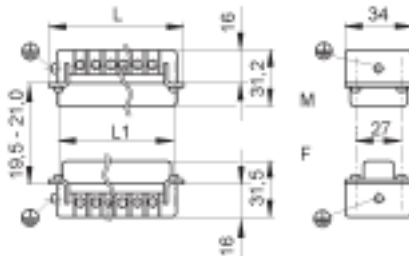

Montageausschnitt
Panel cut-out
Découpe de montage

Schraubanschluss / Screw termination / Raccord à visser

H-BE 24

| Artikel part article | Version version version | Art.Nr. part No. N° art. | Drahtschutz wire protection protection de fil | Kontakte contacts contacts | L | L1 | A |
|----------------------------|-------------------------------|--------------------------------|---|----------------------------------|-----|-----|----|
| H-BE 24 SS | Stift / male / mâle | 10196000 | ● | 24 | 111 | 104 | 98 |
| H-BE 24 BS | Buchse / female / femelle | 10197000 | ● | 24 | 111 | 104 | 98 |
| H-BE 24 SS | Stift / male / mâle | 10196100 | | 24 | 111 | 104 | 98 |
| H-BE 24 BS | Buchse / female / femelle | 10197100 | | 24 | 111 | 104 | 98 |

Gehäuse / Housings / Boîtiers: 3.2: H-B 24
Montageausschnitt siehe vorherige Seite / Panel cut out see previous page / Découpe de montage voir page précédente

Ansicht anschlussseitig
View from cable side
Vue côté raccordement



H-BE 32

| Artikel part article | Version version version | Art.Nr. part No. N° art. | Drahtschutz wire protection protection de fil | Kontakte contacts contacts | L | L1 | A |
|----------------------------|-------------------------------|--------------------------------|---|----------------------------------|------|------|----|
| H-BE 16 SS 1-16 | Stift / male / mâle | 10194000 | ● | 32 | 84,5 | 77,5 | 7 |
| H-BE 16 SS 17-32 | | 10202000 | ● | | 84,5 | 77,5 | 71 |
| H-BE 16 BS 1-16 | Buchse / female / femelle | 10195000 | ● | 32 | 84,5 | 77,5 | 71 |
| H-BE 16 BS 17-32 | | 10203000 | ● | | 84,5 | 77,5 | 71 |
| H-BE 16 SS 1-16 | Stift / male / mâle | 10194100 | | 32 | 84,5 | 77,5 | 71 |
| H-BE 16 SS 17-32 | | 10202100 | | | 84,5 | 77,5 | 71 |
| H-BE 16 BS 1-16 | Buchse / female / femelle | 10195100 | | 32 | 84,5 | 77,5 | 71 |
| H-BE 16 BS 17-32 | | 10203100 | | | 84,5 | 77,5 | 71 |

Gehäuse / Housings / Boîtiers:
3.2: H-B 32

Ansicht anschlussseitig
View from cable side
Vue côté raccordement

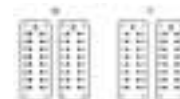

H-BE 48

| Artikel part article | Version version version | Art.Nr. part No. N° art. | Drahtschutz wire protection protection de fil | Kontakte contacts contacts | L | L1 | A |
|----------------------------|-------------------------------|--------------------------------|---|----------------------------------|-----|-----|----|
| H-BE 24 SS 1-24 | Stift / male / mâle | 10196000 | ● | 48 | 111 | 104 | 98 |
| H-BE 24 SS 25-48 | | 10204000 | ● | | 111 | 104 | 98 |
| H-BE 24 BS 1-24 | Buchse / female / femelle | 10197000 | ● | 48 | 111 | 104 | 98 |
| H-BE 24 BS 25-48 | | 10205000 | ● | | 111 | 104 | 98 |
| H-BE 24 SS 1-24 | Stift / male / mâle | 10196100 | | 48 | 111 | 104 | 98 |
| H-BE 24 SS 25-48 | | 10204100 | | | 111 | 104 | 98 |
| H-BE 24 BS 1-24 | Buchse / female / femelle | 10197100 | | 48 | 111 | 104 | 98 |
| H-BE 24 BS 25-48 | | 10205100 | | | 111 | 104 | 98 |

Gehäuse / Housings / Boîtiers:
3.2: H-B 48

Ansicht anschlussseitig
View from cable side
Vue côté raccordement

