

## Battery Holders

### Battery Holders SMT and Through Hole

#### Specifications

- Holder material: heat resistant, glass fiber filled LCP. Flammability rating UL 94 V-0
- Battery contacts: spring stainless steel 301 nickel plated throughout, thickness 10µm. Solder area tin/lead plated throughout, thickness 10µm.
- The contact resistance of the (+) and (-) contacts to the cell is less than 100mOhm (measured through AC 1kHz).

#### Characteristics

- Easy and fast replacement of battery
- Designed for automatic "pick and place" mounting
- Safe retention of button cell
- Automated battery mounting possible
- Clear separation of connections
- Safety against short circuits
- Safety against inverse polarity (polarized)
- Safety against leak currents
- Solid design

# Battery Holders

## Battery Holders SMT and Through Hole (cont.)

### SMT Battery Holders

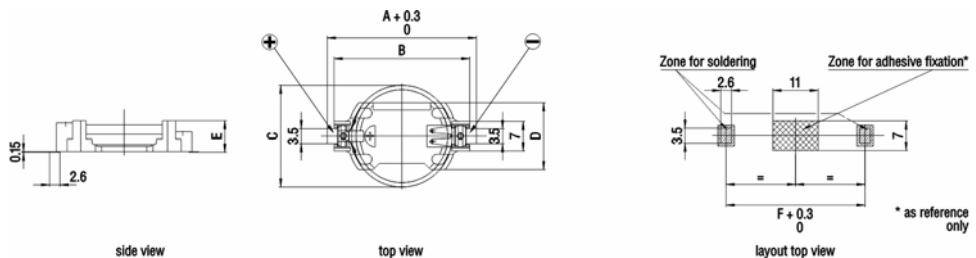
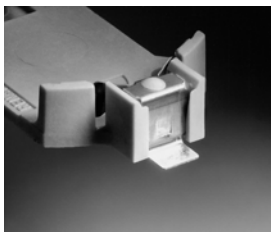

RENATA No.	For use with RENATA cell	Weight (g)	Maximum dimensions (mm)					
			A	B	C	D	E	F
<b>SMTU1225-1</b>	CR1225	0.70	23.7	20.3	12.5	12.7	4.8	21.1
<b>SMTU1632-1</b>	CR1632	0.80	27.7	24.3	16.0	14.5	5.4	25.1
<b>SMTU2032-1</b>	CR2032	0.95	32.0	28.5	20.0	16.1	5.4	29.3
<b>SMTU2430-1</b>	CR2430	1.05	36.5	33.0	24.5	16.1	4.9	33.8
<b>SMTU2450N-1</b>	CR2450N	1.45	36.6	33.0	24.5	16.1	7.5	33.8
<b>SMTU2477N-1</b>	CR2477N	1.65	36.7	33.0	24.5	16.1	10.3	33.8

Rev. 10/02

## Battery Holders

### Battery Holders SMT and Through Hole (cont.)

#### Through Hole

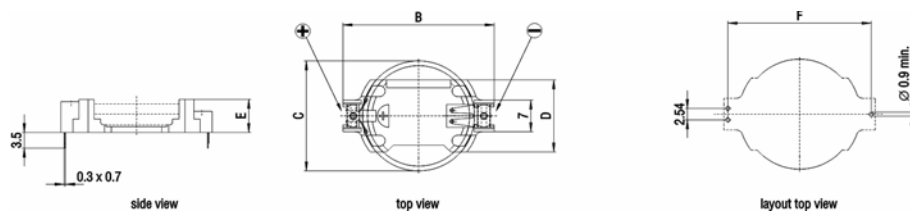
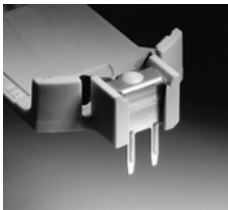

RENATA No.	For use with RENATA cell	Weight (g)	Maximum dimensions (mm)				
			B	C	D	E	F
<b>HU1225-1</b>	CR1225	0.70	20.3	12.5	12.7	4.6	18.7
<b>HU1632-1</b>	CR1632	0.80	24.3	16.0	14.5	5.2	22.7
<b>HU2032-1</b>	CR2032	0.95	28.5	20.0	16.1	5.2	26.9
<b>HU2430-1</b>	CR2430	1.05	33.0	24.5	16.1	4.7	31.5
<b>HU2450N-1</b>	CR2450N	1.45	33.0	24.5	16.1	7.3	31.5
<b>HU2477N-1</b>	CR2477N	1.65	33.0	24.5	16.1	10.1	31.5

Rev. 10/02

# Battery Holders

## Battery Holders SMT and Through Hole (cont.)

### Tape & Reel Packing for SMTU-Battery Holders - Technical Specifications

#### Dimensions and Quantities

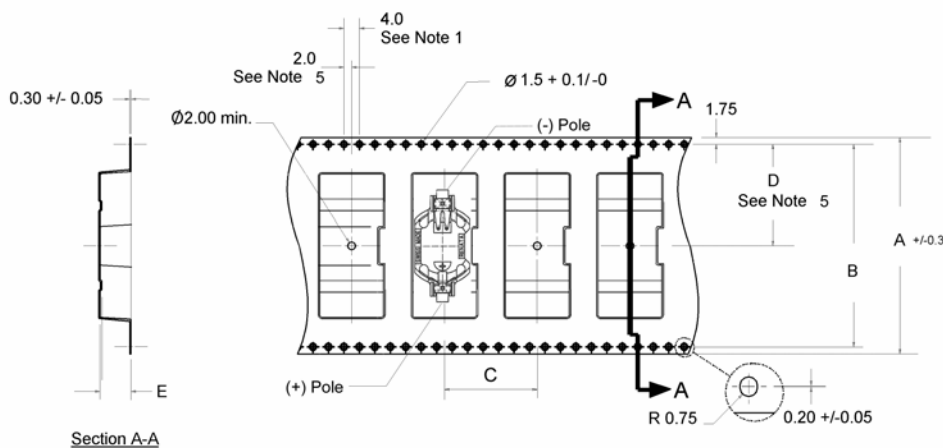

RENATA No.	Quantity per reel	Dimensions (mm)				
		A	B	C	D	E
<b>SMTU1225-1.TR</b>	750 pcs.	44.0	40.4	16.0	20.2	5.7
<b>SMTU1632-1.TR</b>	520 pcs.	44.0	40.4	20.0	20.2	6.1
<b>SMTU2032-1.TR</b>	485 pcs.	44.0	40.4	24.0	20.2	6.0
<b>SMTU2430-1.TR</b>	490 pcs.	56.0	52.4	24.0	26.2	5.7
<b>SMTU2450N-1.TR</b>	350 pcs.	56.0	52.4	24.0	26.2	8.2
<b>SMTU2477N-1.TR</b>	250 pcs.	56.0	52.4	24.0	26.2	10.8

Notes:

1. 10 sprocket hole pitch cumulative tolerance  $\pm 0.02$
2. Camber not to exceed 1 mm in 100 mm

# Battery Holders

## Battery Holders SMT and Through Hole (cont.)

Notes (cont.):

- 3. Material: Black Conductive Advantek Polystyrene
- 4. E measured from a plane on the inside bottom of the pocket to the top surface of the carrier
- 5. Pocket position relative to sprocket hole measured as true position of pocket, not pocket hole

### Dimensions of Antistatic Packaging Reels

RENATA No.	Dimensions (mm)
	W max
<b>SMTU1225-1.TR</b>	50.2
<b>SMTU1632-1.TR</b>	50.2
<b>SMTU2032-1.TR</b>	50.2
<b>SMTU2430-1.TR</b>	62.2
<b>SMTU2450N-1.TR</b>	62.2
<b>SMTU2477N-1.TR</b>	62.2

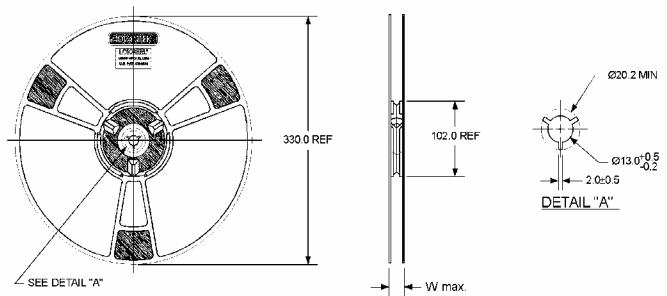

All packaging materials comply with relevant EIA, EIAJ and IEC specifications