

# NEW FROM

# FORGEFIX®

THE SIMPLE SOLUTION

# At last - Fix items securely to drylined (dot and dab) walls!

## The easy to use "dot and dab" Plasterboard Wall Fixings for LCD and Plasma TV Brackets, Kitchen Units, Shelving, Curtain Rails, Mirrors, Radiators and much more. Ideal for new build houses, offices or extensions dry lined in plasterboard.

Plasterboard lined walls (Drylined walls) are now very common in many modern buildings. They are a quick and easy alternative construction method to conventional plastering, and attaching anything to them was a real problem.. until now!

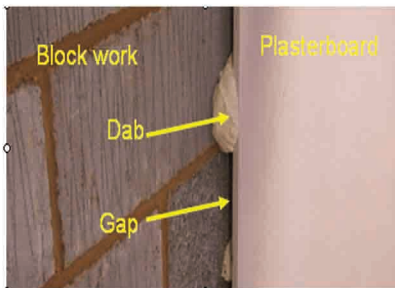
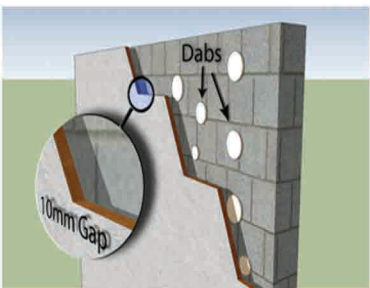

Drylined walls will generally sound "hollow" when you tap them. At certain points they will sound dead. This is a point where the builder has used some adhesive cement to stick the plasterboard to the wall. These walls are a challenge for conventional fixings, as there is an awkward, irregular gap between the plaster and the wall.

## ForgeFix DryLine Pro..... The Ultimate Fixing Solution for Drylined Walls



DrylinePro Plasterboard wall fixings are specifically designed to securely anchor into the wall behind and also grip the plasterboard comfortably, without damaging it. All the "pulling" load on the fixing is taken only by the wall. The shear load ( up/down load ) is taken by the combination of the wall and the plasterboard. Available in two pack sizes. The 8 pack blister and the boxed 50 pack. Both include screws, washers, drill bits and the DryLine Pro fixings.



Code: DLPRO8

Code: DLPRO50

# Probably the best Dryline Fixing available today!