



Choose one component from each of the coloured sections to assemble a complete switch.
For other options or further information please contact your local sales office.

Product Profile

The Series 03 is a high quality switch range that includes pushbuttons, indicators, mushroom headed switches and key switches.

Options include self cleaning snap-action switching elements.

Technical data see page 9

- IP40 or IP65 Protection (with cover)
- Switch Rating, 10A, 400VAC
- Mounting into 21.2x41.2 mm cut out
- Illumination using T6.8 Lamps or LED's
- The standard lenses are available in many different versions, transparent, opaque or translucent
- Screw terminal or plug-in connections

Indicator



Indicator body single with two independent lamp bases, raised, rectangular, black plastic, screw terminals, without bezel

Part No.
03-021.001

Illuminated pushbutton



Illuminated single pushbutton actuator, raised, rectangular, black plastic, screw terminals, without bezel

Part No.	Function	Contact type
03-616.011	Momentary	1 changeover
03-617.011	Momentary	2 changeover
03-618.011	Maintained	1 changeover
03-619.011	Maintained	2 changeover
03-620.011	Momentary/Maintained	2 changeover

For complete switch also order **A**

For complete switch also order **A**

Illuminated pushbutton



Illuminated double pushbutton actuator with independent contacts, raised, rectangular, black plastic, screw terminals, without bezel

Part No.	Function	Contact type
03-624.011	Momentary	2 changeover
03-625.011	Maintained	2 changeover
03-626.011	Momentary/Maintained	2 changeover
03-627.011	Momentary	1 changeover
03-628.011	Maintained	1 changeover

Buzzer



Buzzer, black plastic bezel, raised, rectangular, screw terminals, 10-50VAC/10-75VDC, 85dB ±10 at a distance of 0.1 m, without bezel

Part No.	Contact type
03-810.001	

LED



LED, T6.8, single chip, 12 Volt and 28 Volt.
(Also available in 6 Volt, 24 Volt and 48 Volt)

Colour	Part No.	Voltage
Red	10-2K09.1072	12VAC/DC, 9/17mA
Yellow	10-2K09.1074	12VAC/DC, 9/17mA
Green	10-2K09.1075	12VAC/DC, 9/17mA
Blue	10-2K09.1076	12VAC/DC, 9/17mA
White	10-2K09.1079	12VAC/DC, 9/17mA
Red	10-2K13.1072	28VAC/DC, 9/17mA
Yellow	10-2K13.1074	28VAC/DC, 9/17mA
Green	10-2K13.1075	28VAC/DC, 9/17mA
Blue	10-2K13.1076	28VAC/DC, 9/17mA
White	10-2K13.1079	28VAC/DC, 9/17mA

For complete switch also order **A**

Choose one component from each of the coloured sections to assemble a complete switch.
For other options or further information please contact your local sales office.

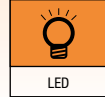

A Accessories



Lens, translucent or opaque/ribbed, one colour for single indicator and pushbutton actuators

Colour	Part No.	Lens
● Red	03-901.2	Translucent
● Yellow	03-901.4	Translucent
● Green	03-901.5	Translucent
● Blue	03-901.6	Translucent
○ White	03-901.9	Opaque/ribbed
● Black	03-901.0	Opaque/ribbed



Lens, translucent/ribbed, two colours for single indicator and pushbutton actuators

Colour	Part No.
● Red/Green	03-902.2/5
● Red/Red	03-902.2/2
○ White/White	03-902.9/9



Lens, translucent or opaque/ribbed, halved for double pushbutton actuators

Colour	Part No.	Lens
● Red	03-921.2	Translucent
● Yellow	03-921.4	Translucent
● Green	03-921.5	Translucent
● Blue	03-921.6	Translucent
○ White	03-921.9	Opaque/ribbed
● Black	03-921.0	Opaque/ribbed

A Accessories



Lens, translucent or opaque/ribbed, halved for mechanically interlocked double pushbutton actuators

Colour	Part No.	Lens
● Red	03-923.2	Translucent
● Yellow	03-923.4	Translucent
● Green	03-923.5	Translucent
● Blue	03-923.6	Translucent
○ White	03-923.9	Opaque/ribbed
● Black	03-923.0	Opaque/ribbed



Front bezel flat and raised, black plastic

Image	Part No.	Product description
1	03-965.0	Front bezel flat
2	03-967.0	Front bezel raised



Sprayproof cover for IP65 sealing and flap guard for pushbutton switch

Image	Part No.	Product description
1	03-924	Sprayproof cover
2	03-925	Flap guard

Series 03

21.2mm x 41.2mm IP40/IP65 10A 400VAC



Choose one component from each of the coloured sections to assemble a complete switch.
For other options or further information please contact your local sales office.

A Accessories



Blanking plate



Lens remover for flat bezel, lens remover for raised bezel and LED remover

Image	Part No.	Image	Part No.	Product description
	03-949.0	1	02-905	Lens remover for flat bezel
		2	98-968	Lens remover for raised bezel
		3	03-996	LED remover

Actuator with snap-action switching element

Switching system

1 or 2 self-cleaning, snap-action switching elements.
1 or 2 double-throw contacts.

Material

Material of contact

Standard version:
Silver (U >20V)
Special versions: (on request)
Gold/Silver 700 Au/300 Ag (U <50V)
Silver/Palladium 700 Ag/300 Pd (U >20V) for atmospheres containing sulphur

Switch housing

Thermosetting material, heat-resistant

Indicator housing

Polyamide

Mechanical characteristics

Terminals

Screw terminal (with self-lifting clip):
max. wire cross-section, 2x2.5mm²
max. wire cross-section of stranded cable, 2x1.5mm²

Plug-in terminal 4.8x0.8mm:
max. wire cross-section of stranded cable, 1mm² can also be used as soldering terminal
max. wire cross-section, 2x1mm²
max. wire cross-section of stranded cable: 2x0.75mm²

Plug-in terminal 4.8x0.8mm:
max. wire cross-section of stranded cable, 2.5mm² can also be used as soldering terminal
max. wire cross-section: 2x1mm²
max. wire cross-section of stranded cable, 2x0.75mm²

Actuating force

6N ... 12N

Actuating travel

5mm

Mechanical lifetime

Momentary action 2 million operations
Maintained action 1 million operations

Storage temperature

-30°C ... +85°C

Electrical characteristics

Standards

The switches comply with the "Standards for low-voltage switching devices" EN IEC 61058-1

Rated insulation voltage

400VAC/440VDC, as per IEC 61058-1

Conventional free air thermal current

10A.

The maximum current in continuous operation and at ambient temperature not exceeding the quoted maximum values.

Switch rating

400VAC, 10A, cosφ 0.95, as per IEC 61058-1
250VAC, 10A, as per UL

Electric strength

2500VAC, 50Hz, 1min. between all terminals and earth, as per IEC 61058-1

Environmental conditions

Storage temperature

-30°C ... +85°C

Service temperature

-25°C ... +55°C

For indicators and illuminated pushbuttons mounted as a block, make sure the heat can escape freely.

Protection degree

Front side IP40, IP65 with spray cover, as per IEC 60529

Vibration resistance

10g at 10-2000Hz, amplitude 1.0mm, as per IEC 60068-2-6

Approvals

Approbations

CB (IEC 61058-1/92)
CSA
ENEC (EN 61058-1/92)
Germanischer Lloyd
UL

Declaration of conformity

CE

Buzzer

Buzzer system

System

Contactless electronic buzzer with IC oscillator

Material

Alarm buzzer case

Duroplastic

Front cap

Polycarbonate (PC)

Front bezel

Polymethylacrylate

Mechanical characteristics

Terminals

Screw terminal

Operating temperature

-25°C ... +55°C

Storage temperature

-40°C ... +85°C

Front protection

IP40

Electrical characteristics

Frequency (tone)

Approx. 2.8 kHz

Sound pressure

85 dB (A) ±8 dB at a distance of 0.1 m

Volume variable with a 1 MΩ potentiometer or corresponding fixed resistor

Operation Voltage/Current

typical

10 ... 55 VAC 10 ... 75 VDC

25 mA 15 mA

Approvals

Approbations

CB (IEC 61058-1/92)

ENEC (EN 61058-1/92)

Declaration of conformity

CE

03 Indicator

Single

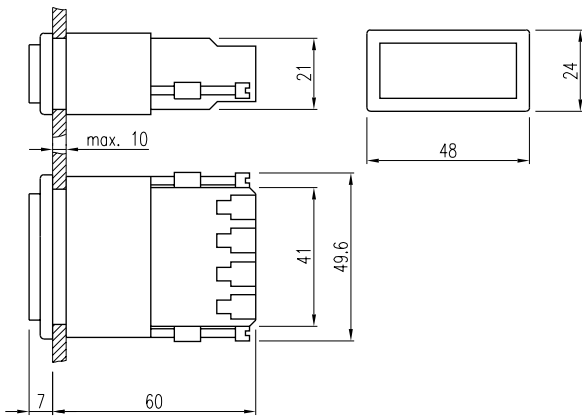

03 Pushbutton

Illuminated, Raised, Single

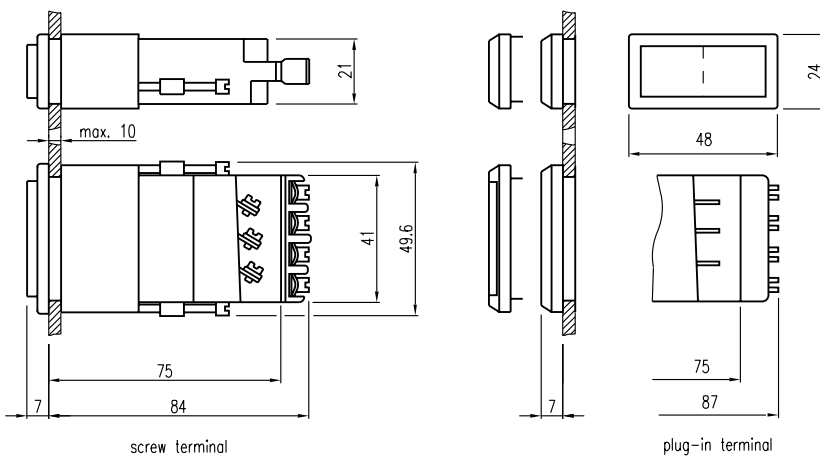

03 Buzzer

Raised

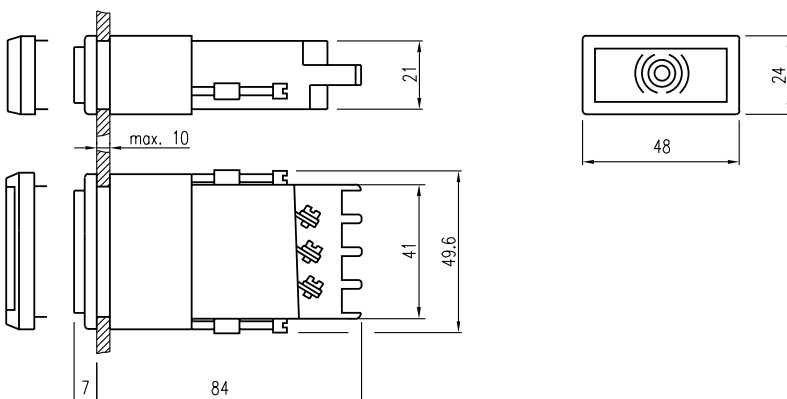

03 Cut-outs, Raised Mounting

