

150-346/347/348/349

TERMINAL MATERIAL :BRASS
 INSULATION MATERIAL :VINYL
 DOUBLE CRIMP :WITH SLEEVE ON BARREL
 MAXIMUM ELECTRICAL RATING :75°C 300 VOLTS

WIRE RANGE A.W.G.	MAXIMUM ELECTRIC CURRENT	INSULATION COLOR
22-16(1.25mm ²)	10 AMPERE	RED
16-14(2mm ²)	15 AMPERE	BLUE
12-10(5.5mm ²)	24 AMPERE	YELLOW

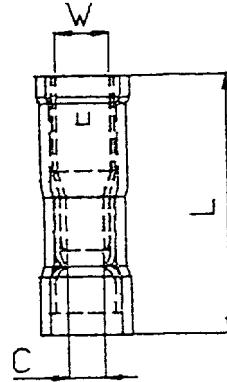
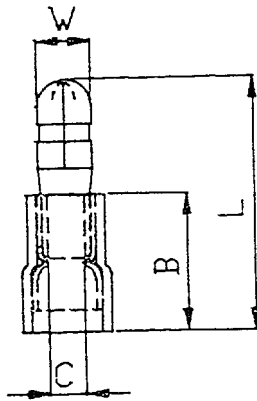

ITEM NO.	DIMENSION				BRASS THICKNE- SS
	W	L	C	B	
MPD1-156	4.0	21.7	1.7	10.5	0.4
MPDL1-156	4.0	23.7			
MPD2-156	4.0	21.7	2.3	10.5	0.4
MPDL2-156	4.0	23.7			
MPD2-195	5.0	21.7			
MPD5-195	5.0	24.0	3.4	13.0	0.4

ITEM NO.	DIMENSION				BRASS THICKNE- SS
	W	L	C	B	
FRD1-156	3.9	23.2	1.7	0.4	
FRD2-156	3.9	22.8	2.3	0.4	
FRD2-195	4.9	22.8	2.3	0.4	
FRD5-195	4.95	25.1	3.4	0.4	

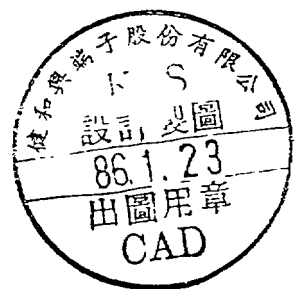

第三角法		單位 UNIT	mm (in)	No	設變內容	日期
圖名 NAME		材 質 MATERIAL		設 計 DESIGN	製 圖 DRAWN	核 對 CHECK
產品編號 ITEM NO	MPD FRD 全系列	數 量 PIECES		陳調慶	黃詩涵	
圖 號 DRAWN NO		比 例 SCALE				
		日 期 DATE	86/01/18			

NYLON TERMINALS

AWG26-22 DIN 0.1-0.5mm ²						
STUD SIZE NYLON INS NON-INS	2mm DRNY2-0.5 DRNB2-0.5	2.5mm DRNY2.5-0.5 DRNB2.5-0.5	3mm DRNY3-0.5 DRNB3-0.5	3.5mm DRNY3.5-0.5 DRNB3.5-0.5	4mm DRNY4-0.5 DRNB4-0.5	5mm DRNY5-0.5 DRNB5-0.5
AWG26-22 DIN 0.1-0.5mm ²						
STUD SIZE NYLON INS NON-INS.	2mm DSNY2-0.5 DSNB2-0.5	3mm DSNY3-0.5 DSNB3-0.5	3.5mm DSNY3.5-0.5 DSNB3.5-0.5	4mm DSNY4-0.5 DSNB4-0.5	5mm DSNY5-0.5 DSNB5-0.5	
AWG26-22 DIN 0.1-0.5mm ²						
	PNYT0.5	BNYT0.5		PTNY0.5-9	FDD0.5-110(5)	FDD0.5-110(8)

MALE & FEMALE DISCONNECTS

FEMALE						
NEMA TAB inch/mm	.110x.020/.032 2.8x0.5/0.8	.187x.020/.032 4.75x0.5/0.8	.205x.020 5.2x0.5	.250x.032 6.35x0.8	.250x.032 6.35x0.8	.375x.048 9.4x1.2
SINGLE CRIMP DOUBLE CRIMP	FDV1-110(5)/(8) FDD1-110(5)/(8)	FDV1-187(5)/(8) FDD1-187(5)/(8)	FDV1-205 FDD1-205	FDV1-250 FDD1-250	FDV5-250 FDD5-250	FDV5-375 FDD5-375
FEMALE						
NEMA TAB inch/mm	.110x.020/.032 2.8x0.5/0.8	.187x.020/.032 4.75x0.5/0.8	.205x.020 5.2x0.5	.250x.032 6.35x0.8	.312x.032 8.0x0.8	.375x.048 9.4x1.2
SINGLE CRIMP DOUBLE CRIMP	FDV2-110(5)/(8) FDD2-110(5)/(8)	FDV2-187(5)/(8) FDD2-187(5)/(8)	FDV2-205 FDD2-205	FDV2-250 FDD2-250	FDV2-312 FDD2-312	FDV2-375 FDD2-375
MALE						
NEMA TAB inch/mm	.110x.020/.032 2.8x0.5/0.8	.187x.020/.032 4.75x0.5/0.8	.250x.032 6.35x0.8	.187x.020/.032 4.75x0.5/0.8	.250x.032 6.35x0.8	.250x.032 6.35x0.8
SINGLE CRIMP DOUBLE CRIMP	MDV1-110(5)/(8) MDD1-110(5)/(8)	MDV1-187(5)/(8) MDD1-187(5)/(8)	MDV1-250 MDD1-250	MDV2-187(5)/(8) MDD2-187(5)/(8)	MDV2-250 MDD2-250	MDV5-250 MDD5-250
FULLY INSULATED FEMALE						
NEMA TAB inch/mm	.187x.020/.032 4.75x0.5/0.8	.250x.032 6.35x0.8	.187x.020/.032 4.75x0.5/0.8	.250x.032 6.35x0.8	.250x.032 6.35x0.8	.375x.048 9.4x1.2
SINGLE CRIMP DOUBLE CRIMP	FDFV1-187(5)/(8) FDFD1-187(5)/(8)	FDFV1-250 FDFD1-250	FDFV2-187(5)/(8) FDFD2-187(5)/(8)	FDFV2-250 FDFD2-250	FDFV5-250 FDFD5-250	FDFV5-375 FDFD5-375

BULLET & RECEPTACLE CONNECTORS

BULLET					PIGGY BACK DISCONNECTS
Ø SIZE SINGLE CRIMP DOUBLE CRIMP	.156/4mm MPV1-156 MPD1-156	.156/4mm MPV2-156 MPD2-156	.195/5mm MPV2-195 MPD2-195	.195/5mm MPV5-195 MPD5-195	
RECEPTACLE					
Ø SIZE SINGLE CRIMP DOUBLE CRIMP	.156/4mm FRV1-156 FRD1-156	.156/4mm FRV2-156 FRD2-156	.195/5mm FRV2-195 FRD2-195	.195/5mm FRV5-195 FRD5-195	.250x.032/6.35x0.8 PBDV1-250 PBDD1-250
FULLY NYLON INSULATED BULLET					
Ø SIZE SINGLE CRIMP DOUBLE CRIMP	.156/4mm MPFNY1-156	.156/4mm MPFNY2-156	.156/4mm MPFNYD1-156	.156/4mm MPFNYD2-156	.250x.032/6.35x0.8 PBDV2-250 PBDD2-250
FULLY NYLON INSULATED RECEPTACLE					
Ø SIZE SINGLE CRIMP DOUBLE CRIMP	.156/4mm FRFNY1-156	.156/4mm FRFNY2-156	.156/4mm FRFNYD1-156	.156/4mm FRFNYD2-156	.250x.032/6.35x0.8 PBDV5-250 PBDD5-250

STUD SIZE: mm - Inch mm - Inch
 3.2 - #4 6.4 - 1/4"
 3.7 - #6 8.4 - 5/16"
 4.3 - #8 10.5 - 3/8"
 5.3 - #10 13.0 - 1/2"

INSULATED COLOR & WIRE RANGE: YELLOW: 0.5mm² =AWG26-22=DIN 0.1-0.5mm²
 RED: 1.25mm² =AWG22-16=DIN 0.5-1.5mm²
 BLUE: 2mm² =AWG16-14=DIN 1.5-2.5mm²
 YELLOW: 5.5mm² =AWG12-10=DIN 2.5-6mm²

* WITH PVC/NYLON/PC/HEAT SHRINKABLE TUBE INSULATION. NORMAL ENTRY,EASY ENTRY,SINGLE CRIMP,
 DOUBLE CRIMP + TIN/SILVER/GOLD PLATING ALL AVAILABLE